



**FISU**  
WORLD  
UNIVERSITY  
GAMES  
WINTER

# **TECHNICAL HANDBOOK ALPINE SKIING**

**December 2022**



## TABLE OF CONTENTS

1. Welcome Messages.....	4
2. Abbreviations.....	8
3. FISU International Technical Committee .....	9
4. General Information .....	10
4.1 Lake Placid 2023 FISU World University Games .....	10
4.2 Competition Schedule.....	10
4.3 Opening and Closing Ceremonies .....	11
5. Competition Schedule.....	11
5.1 Technical Committee .....	11
5.2 International Technical Officials .....	11
5.3 Competition Structural Chart .....	12
5.4 Technical Regulations .....	12
5.4.1 Jury Composition .....	13
5.4.2 Protest and Appeal .....	14
5.5 Competition Format.....	14
5.5.1 Draws SG, GS and SL .....	14
5.5.2 Super-G (SG) .....	14
5.5.3 Giant Slalom (GS) .....	14
5.5.4 Slalom (SL) .....	15
5.5.5 Alpine Combined.....	15
5.5.6 Mixed Team Parallel.....	15
5.6 Competition and Training Venue Information.....	17
5.6.1 General Information .....	17
5.6.2 Venue Layouts.....	17
5.6.3 Slopes Technical Data.....	17
5.7 Day-by-Day Schedule.....	18
5.7.1 Ceremonies .....	22
5.7.2 Training .....	23
5.7.3 Reserve Days .....	23
5.7.4 General Technical Meeting.....	23
5.8 Equipment .....	23
5.8.1 Competition Uniforms & Equipment .....	23
5.8.2 Equipment control And Schedule .....	24

5.8.3 Storage and Wax Rooms .....	24
5.8.4 Waxing Room Equipment .....	25
5.9 Doping Control .....	25
5.9.1 List of Prohibited Substances .....	25
5.9.2 Testing .....	26
5.9.3 Doping Control Stations .....	26
5.9.4 Therapeutic Use Exemptions (TUE) .....	27
5.9.5 Structure .....	27
5.10 Mascots and Medals .....	27
5.10.1 Mascot Ceremony .....	27
5.10.2 Medal Ceremony .....	27
5.10.3 Diploma of Honor .....	28
5.11 Media Interviews .....	28
5.12 Sport Information Services .....	29
5.12.1 Online Sport Information Services .....	29
5.12.2 Sport Information Center (SIC) .....	29
5.12.3 Sport Information at the Venue .....	29
5.12.4 Sport Information Distribution .....	30
6. Service Information .....	30
6.1 Accreditation .....	30
6.2 Radio Frequency Control .....	31
6.3 Insurance and Responsibilities .....	31
6.4 Transportation .....	31
6.4.1 Transportation System for Athletes and Team Officials (TA) .....	31
6.5 Food and Beverages .....	32
6.5.1 Mealtimes .....	32
6.5.2 FNB Services at the Competition Venues .....	32
6.6 Medical Services .....	33
6.6.1 Conditions of Medical Assistance .....	33
6.6.2 Medical Support Structure .....	33
6.6.3 Medical Support in the Accommodation Sites .....	33
6.6.4 Dedicated Hospitals and Specialized Medical Facilities .....	33
6.7 Weather and Climate .....	33
7. OC Contacts .....	34

8. Appendices.....	35
8.1 Lake Placid 2023 FISU World University Games Competition Schedule .....	35
8.2 Venue Layouts.....	36
8.2.1 Venue Plans .....	36
8.2.2 Overview Slopes .....	37
8.3 Geographical Overview Venues .....	40

## 1. WELCOME MESSAGES

*Dear Delegates,  
Dear Friends and Colleagues,*

*Thank you for your participation in the Lake Placid 2023 FISU World University Games. I would like to recognize the Organizing Committee and FISU for their hard work and dedication—without them, this event would not be possible. The past months have been very important as we put together the final touches to welcome the world's best collegiate-athletes to participate in these FISU Games.*

*The recent HoD meeting was very successful and as we get closer to the Lake Placid 2023 FISU Games it becomes even more exciting to call Lake Placid a two-time host, since they held the FISU Games in 1972. It is obvious that international events come naturally to the region, therefore, we are confident that Lake Placid is ready to welcome the world's best collegiate-athletes to their stage once again.*

*We would like to thank each and every one of you for your participation and hope you will spend the next 11 days discovering what this beautiful village in New York State and Adirondack Region has to offer. We are excited to see the result of your hard work and dedication that has gone into the preparation for these Games and are looking forward to having you with us in Lake Placid.*

*I wish you all good luck and hope you have a great stay in Lake Placid!*

*Thank you.*



*Leonz Eder  
Acting President of the  
International University Sports Federation*

*Dear Technical Delegates and Officials,*

*I look forward to welcoming you to Lake Placid, N.Y. and the surrounding North Country region, where the Lake Placid 2023 FISU World University Games will soon be underway. It is a privilege and honor to once again the host the World in our historic village!*

*As a community known for its rich sporting history, Lake Placid is proudly home to the 1932 and 1980 Olympic Winter Games, the 1972 FISU World University Games and countless World Cup and World Championship events. In preparation for the upcoming Lake Placid 2023 FISU Games, the venues have undergone extensive modernizations to provide world class facilities for decades to come, ensuring the continuation of our sporting legacy.*

*I am pleased to welcome you to my hometown and the surrounding North Country region. This technical handbook is intended to provide you with all the information you need to guide you through your time here. I wish each of the participating collegiate-athletes success and hope everyone leaves with unforgettable memories that are shared for years to come!*

*Sincerely,*



Ashley Walden  
Chief Operating Officer of the  
Lake Placid 2023 FISU World University Games

*Dear Delegations,*

*Welcome to the Lake Placid 2023 FISU World University Games! Lake Placid, our Adirondack Region and the State of New York thank you for your dedication to University sport and we welcome you to our home with open arms.*

*As hosts of the 1972 FISU World University Games, we are excited to continue Lake Placid's legacy as a global center of international sport by again welcoming collegiate-athletes from across the globe.*

*The Organizing Committee recognizes our duty to support collegiate-athletes in their efforts to achieve excellence in their chosen disciplines by providing top-of-the-line competition venues and an unforgettable experience. With this in mind, we have worked to ensure that all participants have an opportunity to showcase their talents as they compete with cooperation and respect for one another.*

*Enjoy competition, enjoy our village, our region and our state so that you may leave Lake Placid with added and renewed feelings about the positive benefits of international University sport.*

*Please reach out to us as you may wish.*

*With all good wishes,*



*James B. McKenna  
President of the  
Lake Placid 2023 FISU World University Games*

## 2. ABBREVIATIONS

Abbreviation	Name in Full
AC	Alpine Combined
ADAMS	Anti-Doping Administration and Management System
ALP	Alpine Skiing
CIC	FISU International Control Committee
CMI	FISU International Medical Committee
CPH	Crowne Plaza Hotel
CT	FISU Technical Committee
EC	FISU Executive Committee
FIS	International Ski Federation
FISU	International University Sports Federation
FNB	Food & Beverage
GS	Giant Slalom
GTM	General Technical Meeting
HoD	Head of Delegation
IF	International Federation
ITC	FISU World University Games International Technical Committee
ITO	International Technical Official
LOC	Local Organizing Committee
NADO	National Anti-Doping Organization
NF	National Federation
NTO	National Technical Official
NUSF	National University Sports Federation
OC	Organizing Committee



OCN	Olympic Center
RD	Race Director
SG	Super-G
SIC	Sports Information Center
SID	Sports Information Desk
SL	Slalom
TD	Technical Delegate
TCC	FISU Technical Committee Chair
TCM	Team Captain's Meeting
TO	Technical Official
TP	Mixed Team Parallel
TUE	Therapeutic Use Exemptions
VNS	Northwood School
WADA	World Anti-Doping Agency
WFM	Whiteface Mountain

### 3. FISU INTERNATIONAL TECHNICAL COMMITTEE

Position	First Name	Last Name	Country
FISU TCC ALP	Matjaz	Kranjc	SLO
FISU TCC BTH	Ondrej	Rybar	CZE
FISU TCC CCS	Zofia Stefania	Kielpinska	POL
FISU TCC NCB	Karl	Lustenberger	SUI
FISU TCC SJP	Paul	Ganzenhuber	AUT
FISU TCC FRS	Magnus	Ferry	SWE
FISU TCC SBD	Ola	Sundekvist	SWE

FISU TCC CUR	Scott	Arnold	CAN
FISU TCC IHO	Reto	Bertolotti	SUI
FISU TCC IHO	Igor	Nemecek	SVK
FISU TCC FSK	Dingding	Liu	CHN
FISU TCC STK	So Hee	Kim	KOR
FISU TCC SSK	Moyca	Stoffel	CAN

## 4. GENERAL INFORMATION

### 4.1 Lake Placid 2023 FISU World University Games

Date: 12- 22 January 2023

Location: Lake Placid, New York

Sports Program: 12 sports, 86 Medal Events

Venues: 9 venues

### 4.2 Competition Schedule



## 4.3 Opening and Closing Ceremonies

### Opening Ceremony

Date: 12 January 2023

Location: Olympic Center, 1980 Herb Brooks Arena

Beginning of Ceremony: 19:00

### Closing Ceremony

Date: 22 January 2023

Location: Olympic Center, 1980 Herb Brooks Arena

Beginning of Ceremony: 17:10

## 5. COMPETITION SCHEDULE

### 5.1 Technical Committee

FISU Technical Committee Chair	Matjaz Kranjc (SLO)
FIS Technical Delegate (M)	Stefano Pirola (CHI)
FIS Technical Delegate (W)	Julie Klotz (CAN)
Sport Manager/Chief of Course Speed & Tech	John Norton (USA)
Chief of Competition	Paul Van Slyke (USA)
Race Secretary	Chris Grant (USA) Thelma Hoessler (USA)

### 5.2 International Technical Officials

FIS Alpine Equipment Controller	Matjaz Vrecl (SLO)
---------------------------------	--------------------

### 5.3 Competition Structural Chart

Venue Manager		FISU TCC
Aaron Kellett		Matjaz Kranjc
Security	Sport Manager	FIS TDs
Michael Ryan	John Norton	Julie Klotz (W) Stefano Pirola (M)

### 5.4 Technical Regulations

The Alpine Skiing events will be organized in accordance with the most recent technical regulations of the International Ski Federation (FIS), except when specifically amended by these regulations or by the FISU Games International Technical Committee (FISU Games ITC).

The program and duration of the competitions will be fixed by the FISU Executive Committee in agreement with the Organizing Committee and the FISU Games ITC. In principle, the program will last eight (8) days and will include the following events:

#### Men

- Super G (SG)
- Giant Slalom (GS)
- Slalom (SL)
- Alpine Combined (AC)

#### Women

- Super G (SG)
- Giant Slalom (GS)
- Slalom (SL)
- Alpine Combined (AC)

#### Men/ Women

- Mixed Team Parallel (TP)

Each country is authorized to enter a maximum of 12 athletes per gender (total 24 athletes).



In each event, each country may enter:

- Individual events: maximum six (6) athletes (per gender)
- Team events:
  - Mixed Team Parallel: maximum one (1) team per country composed of two (2) W and 2 M.
  - After the TP draw, changes or replacement of the racers are not allowed (even in case of injury)

Only athletes with an active FIS code are allowed to participate in each Alpine Skiing event.

To be eligible for participation in Super-G and Alpine Combined the athlete must have FIS points in Super-G, Alpine Combined or Downhill.

If an athlete does not yet appear in the valid FIS points list, he/she may only participate on the condition that an official results list containing his/her previous results is presented.

Entries are controlled by the Organizing Committee and the FIS Technical Delegate.

At the first General Technical Meeting, the Head of Delegation or his/her representative shall confirm and sign the official entry list of athletes.

Only with an accreditation card approved by the FISU International Control Committee (CIC) can an athlete be considered for the draw of a starting list and be entitled to participate in any of the competitions.

#### **5.4.1 JURY COMPOSITION**

Members of Jury (Rules for FIS-UNI Competitions– Edition 2018/19):

In accordance with ICR Rules (601.4) for all events (men and women), the Jury must be nominated with the following members:

- TD FIS (one (1) for men and one (1) for women nominated by FIS)
- TD FISU-TCC (nominated by FISU) takes the function of Referee
- Assistant Referee (only for speed events) proposed by FISU and nominated by the TD FIS
- Chief of Race (nominated by Organizing Committee)
- The second (2nd) nominated TD FIS could be proposed to act as Start Referee or Finish Referee or video controller

All Jury members must be able to communicate with the Local Organizing Committee and with all Jury members by radio during the competitions (ICR 601.4.1.5) in one of the official FIS languages.

## Connecting Coach

The Jury has the right to nominate a Connecting Coach at the Technical Committee's Meeting who will work together with the Jury and the other coaches but will not be a Jury member.

### 5.4.2 PROTEST AND APPEAL

Any protest of a sport or disciplinary nature must reach the Jury according to the regulations laid down by the FIS. Such protest must be accompanied by a deposit in cash of CHF 100 or equivalent in the currency of the Organizing Committee (FIS ICR Art. 644; 644.4). This deposit will be returned if the protest is upheld.

Each Head of Delegation or his/her deputy is authorized to lodge an appeal against the decision of the Jury. This appeal must be submitted in writing to the Jury of Appeal or competent authority in accordance with the FIS regulations. Any decision of the Jury of Appeal or equivalent authority of a sport is final and must be reported immediately to the Head of Delegation of the country concerned.

Any sport disciplinary situation which cannot be satisfactorily resolved by the Sport Technical Committee (TC) and the sport-specific disciplinary regulations will be reported to the FISU Disciplinary Committee for further action to be taken. Where appropriate, a report will also be sent to FIS.

## 5.5 Competition Format

### 5.5.1 DRAWS SG, GS AND SL

- Draw according to the FIS ICR art. 621.3. The starting order of the competitors in all Alpine Skiing competitions is determined by their FIS points in the concerned discipline. A first (1st) group with a maximum of the 15 best competitors present regardless of nationality, will be drawn.
- The group may be increased if two (2) or more competitors share the 15th rank.
- All remaining competitors start in order of their FIS points. All competitors without FIS points will be drawn in the last group.

### 5.5.2 SUPER-G (SG)

- FIS Race Level 1 (minimum FIS points penalty: 15)
- The Super-G is carried out in one (1) run.

### 5.5.3 GIANT SLALOM (GS)

- FIS Race Level 1 (minimum FIS points penalty: 15)
- The GS event consists of two (2) runs.

#### 5.5.4 SLALOM (SL)

- FIS Race Level 1 (minimum FIS points penalty: 15)
- The Slalom event consists of two (2) runs.

#### 5.5.5 ALPINE COMBINED

- Starting numbers given to the competitors for the first run remain the same for all runs.
- The results of Combined competitions are only counted for FIS points if the competitor finishes both combined races (SG and SL).
- The Combined results are calculated by adding the race times of the single events or runs.
- Each competitor finishing the first race of AC is qualified for the second (2<sup>nd</sup>) race.
- The start order is determined for each event according to art. 621.
- Only interim results may be published for those events or runs already completed. The official results are only published when all events or runs have been completed.
- The sequence of the different races to be combined may be decided by the Organizing Committee and must be announced in the race notice and the program. Changes may be made by the Jury.

#### 5.5.6 MIXED TEAM PARALLEL

- The Mixed Team Parallel event (SL version) will be conducted as a parallel using Giant Slalom gates and panels.
- The total team size per Nation is limited to a maximum of 4 athletes (2 women and 2 men). A competitor can only start a run once.

#### Team Entry:

- The teams' entry confirmations for the Mixed Team Parallel (TP) (with names of participating athletes) must be submitted at the TCM scheduled in Lake Placid on 11 January 2023.
- Maximum 16 Teams may participate in the final phase.
- If more than 16 teams enter the competition, then a qualification phase will be organized to assign the last places for the final. There will be a reset of the gates after the qualification phase.

#### Team Ranking:

- The teams will be ranked in accordance with the FIS - PWSL points, from lowest total points to highest.

#### Seeding of the Teams (FIS ICR 1212.5)

The teams entered will be seeded into eight (8) heats based upon their ranking. A bracket list will be arranged as follows:

- Heat 1: Nation ranked 1 vs. Nation ranked 16
- Heat 2: Nation ranked 8 vs. Nation ranked 9
- Heat 3: Nation ranked 5 vs. Nation ranked 12
- Heat 4: Nation ranked 4 vs. Nation ranked 13
- Heat 5: Nation ranked 3 vs. Nation ranked 14
- Heat 6: Nation ranked 6 vs. Nation ranked 11
- Heat 7: Nation ranked 7 vs. Nation ranked 10
- Heat 8: Nation ranked 2 vs. Nation ranked 15
- The highest-ranking nation, according to the team ranking, will receive bib number 1 and the lowest ranking nation will receive the last bib number.
  - Women will receive bibs starting from one (1), and Men starting from five (5), in alphabetical order. If a heat is incomplete, the remaining nation will automatically qualify for the next round (a bye).
- For each individual leg of the heat, the competitor who is listed first, or respectively on top of the pairing, will start on the red course for his/her first run.

Following the order in the bracket, from top to bottom, all groups race in succession. For the second (2<sup>nd</sup>) individual leg of the heat, the competitors change courses. All subsequent runs are conducted using this system.

#### Running the Competition:

- Each individual leg between two opponents consists of one (1) run.
- The start order will be as follows (as an example for Heat 1):
- "Course Red" Nation 1 W1 vs. "Course Blue" Nation last W1
- "Course Red" Nation 1 M1 vs. "Course Blue" Nation last M1
- "Course Blue" Nation 1 W2 vs. "Course Red" Nation last W2
- "Course Blue" Nation 1 M2 vs. "Course Red" Nation last M2
- The blue course will be located on the skier's right.
- The starting order cannot be changed from one heat to the next.

#### Round of 16:

- The 16 teams start according to the start system in pairs from top to bottom. There are eight (8) that qualify for the quarterfinals. The lowest-ranked eight teams receive the same rank (9th).

#### Quarter Finals:

The eight (8) qualified teams start according to the start table. The lowest-ranked four (4) teams receive the same rank (5th).

#### Semi-Finals and Final:

The four (4) qualified teams start according to the start table. The lowest-ranked teams from the semi-finals race in the 3rd and 4th positions and the highest-ranked teams race in the 1st and 2nd



positions.

#### Points Scoring:

- The winners of each individual leg score one (1) point for their Nation. In the event of a tie of an individual leg, both nations are awarded one (1) point.
- If there is a tie at the end of the heat (example 2:2) the Nation with the lowest combined time of the best individual woman and the best individual man run time (or second best in the event of a tie for the best time) will win the heat.
- If both competitors fall in any leg, the first competitor to reach the finish successfully will be announced as the winner. If both competitors fail to finish, the competitor who successfully skied the furthest distance will be announced as the leg winner.

#### Reasons for Disqualifications (immediate and without protest):

- Changing from one course to another
- Interfering with the opponent, accidentally or not
- Not passing through a gate correctly (art. 661.4.2)
- Stepping back (art. 614.2.3)

## 5.6 Competition and Training Venue Information

### 5.6.1 GENERAL INFORMATION

OC VENUE MANAGER		Aaron Kellett	
Venue	Function	Location	Distance from accommodation to Venue
Whiteface Mountain	Training/ Competition	5021 NYS Route 86, Wilmington, NY 12997	20 miles (32.2 km)

### 5.6.2 VENUE LAYOUTS

See Appendix, Section 8.2.

### 5.6.3 SLOPES TECHNICAL DATA

See Appendix, Section 8.2.2.

## 5.7 Day-by-Day Schedule

*“For all televised events, the competition session begins at the stated time, but the actual competition/play will begin five (5) minutes afterwards for broadcast purposes.”*

Key	
Training	Light Blue
Competition	Dark Blue
Reserve Days	White
Meeting Days/Additional Information	Yellow
Ceremonies/Social Events	Red

SPORT	DATE	DAY	START TIME	FINISH TIME	EVENT NAME	VENUE
Alpine Skiing	8-Jan-23	SUN	13:00	15:00	Technical Committee Inspection	WFM
Alpine Skiing	9-Jan-23	MON	17:00	19:00	FISU International Technical Committee (ITC) Meeting	CPH
Alpine Skiing	11-Jan-23	WED	09:00	16:00	Unofficial Training	WFM
Alpine Skiing	11-Jan-23	WED	15:00	16:00	1st Technical Committee Meeting	VNS
Alpine Skiing	11-Jan-23	WED	16:30	18:30	1st General Technical Meeting (Team Captain's Meeting)	VNS
Alpine Skiing	12-Jan-23	THU	10:00	12:00	Official Free-Ski on SG course	WFM
Alpine Skiing	12-Jan-23	THU	15:00	16:00	Team Captain's Meeting - Draw SG	VNS
Alpine Skiing	12-Jan-23	THU	19:00	20:30	Opening Ceremony	OCN
Alpine Skiing	13-Jan-23	FRI	10:00	11:30	SG W	WFM

Alpine Skiing	13-Jan-23	FRI	immediately following		Mascot Ceremony SG W	WFM
Alpine Skiing	13-Jan-23	FRI	13:00	15:00	SG M	WFM
Alpine Skiing	13-Jan-23	FRI	immediately following		Mascot Ceremony SG M	WFM
Alpine Skiing	13-Jan-23	FRI	18:00	20:00	Medal Ceremony SG M and W	MID
Alpine Skiing	13-Jan-23	FRI	18:00	19:00	Team Captain's Meeting - Draw AC W	VNS
Alpine Skiing	14-Jan-23	SAT	08:30	09:15	Course Inspection AC/SG	WFM
Alpine Skiing	14-Jan-23	SAT	09:30	11:00	AC/SG W	WFM
Alpine Skiing	14-Jan-23	SAT	12:00	12:45	Course Inspection AC/SL	WFM
Alpine Skiing	14-Jan-23	SAT	13:00	14:00	AC/SL W	WFM
Alpine Skiing	14-Jan-23	SAT	after 30 competitors in 2nd run		Mascot Ceremony AC W	WFM
Alpine Skiing	14-Jan-23	SAT	18:00	20:00	Medal Ceremony AC W	MID
Alpine Skiing	14-Jan-23	SAT	18:00	19:00	Team Captain's Meeting - Draw AC M	VNS
Alpine Skiing	15-Jan-23	SUN	08:30	09:15	Course Inspection AC/SG	WFM
Alpine Skiing	15-Jan-23	SUN	09:30	11:00	AC/SG M	WFM

Alpine Skiing	15-Jan-23	SUN	12:00	12:45	Course Inspection AC/SL	WFM
Alpine Skiing	15-Jan-23	SUN	13:00	14:00	AC/SL M	WFM
Alpine Skiing	15-Jan-23	SUN	after 30 competitors in 2nd run		Mascot Ceremony AC M	WFM
Alpine Skiing	15-Jan-23	SUN	18:00	20:00	Medal Ceremony AC M	MID
Alpine Skiing	16-Jan-23	MON			Reserve Day	WFM
Alpine Skiing	16-Jan-23	MON	18:00	19:00	Team Captain's Meeting - Draw GS W	VNS
Alpine Skiing	17-Jan-23	TUE	08:30	09:15	Course Inspection GS W	WFM
Alpine Skiing	17-Jan-23	TUE	09:30	11:00	GS W 1st Run	WFM
Alpine Skiing	17-Jan-23	TUE	11:30	12:15	Course Inspection GS W	WFM
Alpine Skiing	17-Jan-23	TUE	12:30	14:00	GS W 2nd Run	WFM
Alpine Skiing	17-Jan-23	TUE	after 30 competitors in 2nd run		Mascot Ceremony GS W	WFM
Alpine Skiing	17-Jan-23	TUE	18:00	20:00	Medal Ceremony GS W	MID
Alpine Skiing	17-Jan-23	TUE	18:00	19:00	Team Captain's Meeting - Draw GS M	VNS
Alpine Skiing	18-Jan-23	WED	08:30	09:15	Course Inspection GS M	WFM



Alpine Skiing	18-Jan-23	WED	09:30	11:30	GS M 1st Run	WFM
Alpine Skiing	18-Jan-23	WED	11:30	12:15	Course Inspection GS M	WFM
Alpine Skiing	18-Jan-23	WED	13:00	15:00	GS M 2nd Run	WFM
Alpine Skiing	18-Jan-23	WED	after 30 competitors in 2nd run		Mascot Ceremony GS M	WFM
Alpine Skiing	18-Jan-23	WED	18:00	20:00	Medal Ceremony GS M	MID
Alpine Skiing	18-Jan-23	WED	18:00	19:00	Team Captain's Meeting - Draw TP	VNS
Alpine Skiing	19-Jan-23	THU	09:00	10:30	Inspection/Training	WFM
Alpine Skiing	19-Jan-23	THU	11:00	13:00	Mixed Team Parallel (TP) Final	WFM
Alpine Skiing	19-Jan-23	THU	immediately following		Mascot Ceremony TP W/M	WFM
Alpine Skiing	19-Jan-23	THU	18:00	20:00	Medal Ceremony TP W/M	MID
Alpine Skiing	19-Jan-23	THU	18:00	19:00	Team Captain's Meeting - Draw SL W	VNS
Alpine Skiing	20-Jan-23	FRI	08:30	09:15	Course Inspection SL W	WFM
Alpine Skiing	20-Jan-23	FRI	09:30	11:00	SL W 1st Run	WFM
Alpine Skiing	20-Jan-23	FRI	11:30	12:15	Course Inspection SL W	WFM
Alpine Skiing	20-Jan-23	FRI	12:30	14:00	SL W 2nd Run	WFM

Alpine Skiing	20-Jan-23	FRI	after 30 competitors in 2nd run		Mascot Ceremony SL W	WFM
Alpine Skiing	20-Jan-23	FRI	18:00	20:00	Medal Ceremony SL W	MID
Alpine Skiing	20-Jan-23	FRI	18:00	19:00	Team Captain's Meeting - Draw SL M	VNS
Alpine Skiing	21-Jan-23	SAT	08:30	09:15	Course Inspection SL M	WFM
Alpine Skiing	21-Jan-23	SAT	09:30	11:30	SL M 1st Run	WFM
Alpine Skiing	21-Jan-23	SAT	11:30	12:15	Course Inspection SL M	WFM
Alpine Skiing	21-Jan-23	SAT	13:00	15:00	SL M 2nd Run	WFM
Alpine Skiing	21-Jan-23	SAT	after 30 competitors in 2nd run		Mascot Ceremony SL M	WFM
Alpine Skiing	21-Jan-23	SAT	18:00	20:00	Medal Ceremony SL M	MID
Alpine Skiing	22-Jan-23	SUN			Reserve Day	WFM
Alpine Skiing	22-Jan-23	SUN	17:10		Closing Ceremony	OCN

#### 5.7.1 CEREMONIES

Mascot Ceremonies will be held immediately following the conclusion of the competition. In SL, AC and GS, the Mascot Ceremonies will be held after 30 runners have completed the second (2<sup>nd</sup>) run. Medal Ceremonies for Super-G, Alpine Combined, Giant Slalom, Mixed Team Parallel and Slalom will be held at Mid's Park – Medals Plaza.

For more information, please refer to Section 5.10

#### **5.7.2 TRAINING**

Official Free Skiing on Super-G courses takes place on 12 January. More details can be found below, in Section 5.8. Unofficial training is available 8-11 January, with transportation provided by the OC. Exact times for those training windows are still being finalized with OC Transportation, along with any applicable training booking process, and this will be communicated to all Delegations as soon as possible.

#### **5.7.3 RESERVE DAYS**

The OC will do its best to hold all competitions on the scheduled days. However, under exceptional weather conditions the competitions may have to be postponed/rescheduled. Two (2) reserve days are kept free, 16 January and 22 January.

#### **5.7.4 GENERAL TECHNICAL MEETING**

- The 1st General Technical Meeting (Team Captain's Meeting) will be held from 16:30 – 18:30 on 11 January 2023 at Northwood School (VNS).
- The Head of Delegation or his/her representative and their coach must attend the 1st Technical Committee Meeting.
- At the 1st General Technical Meeting, the Head of Delegation or his/her representative shall confirm and sign the official list of competitors. Only athletes with an active FIS code are allowed to participate in each Alpine Skiing event.
- Entries are controlled by the Organizing Committee and the FIS Technical Delegate.
- Only accredited athletes can be considered for the draw of a starting list.

Any further details and clarifications which are not yet described in the Technical Handbook will be communicated at the respective Team Captain's Meetings (please refer to the schedule above).

### **5.8 Equipment**

#### **5.8.1 COMPETITION UNIFORMS & EQUIPMENT**

Clothing and equipment control will in principle follow FIS rules. The equipment control will be carried out in respect of the recent FIS technical regulations if no additional FISU rule is determined. Each competitor is responsible for the equipment that he/she uses (skis, bindings, poles, ski boots, suit, etc.). The term "competition equipment" encompasses all items of equipment which the competitor uses in competition. This includes clothing as well as apparatus with technical functions including helmets for SG and GS. The entire competition equipment forms a functional unit. All equipment used by athletes is governed by the FIS Specifications for Alpine Competition Equipment: See FIS Rules.

### 5.8.2 EQUIPMENT CONTROL AND SCHEDULE

Schedule (Subject to change)

11 Jan 2023

- 14:00 – 16:00 - Preliminary Equipment Control SG W (Northwood School)
- 16:00 – 18:30 - Preliminary Equipment Control SG M (Northwood School)

12 Jan 2023

- 10:00 – 12:00 - Preliminary Equipment Control (SG start)
- 14:00 – 16:00 - Preliminary Equipment Control SG W + M (Alternative termin) (Northwood School)

13 Jan 2023 - Race day SG W + M

- 09:30 – 14:00 – Equipment Control (SG Finish)

14 Jan 2023 - Race day AC W

- 09:30 – 14:00 – Equipment Control (SG/SL Finish)

15 Jan 2023 - Race day AC M

- 10:00 – 14:00 – Equipment Control (SG/SL Finish)

16 Jan 2023

- 14:00 – 16:00 - Preliminary Equipment Control GS W (Northwood School)
- 16:00 – 18:30 - Preliminary Equipment Control GS M (Northwood School)

17 Jan 2023 - Race day GS W

- 09:30 – 14:00 – Equipment Control (GS Finish)

18 Jan 2023 - Race day GS M

- 09:30 – 15:00 – Equipment Control (GS Finish)

19 Jan 2023 - Race day Mixed Team Parallel

- 11:00 – 13:00 (Start)

### 5.8.3 STORAGE AND WAX ROOMS

The Lake Placid 2023 FISU World University Games will provide sport equipment storage and waxing rooms for the teams. All facilities are built and organized according to FISU and international requirements. Waxing rooms and cabins for Alpine will be provided on site at the Northwood School sport facility. Sections will be allocated to the respective nations and shared among their athletes.



The waxing rooms are equipped with special tables and equipment for preparing skis with lighting, several electric outlets\*, heating and ventilation, ski racks and waste bins.

#### **5.8.4 WAXING ROOM EQUIPMENT**

For Alpine, Freeski & Freestyle and Snowboard, the LOC will provide Swix waxing benches (expected model is T0075W – waxing bench wide) in each waxing cabin/area.

Each waxing area (for all relevant sports) will have an ample supply of U.S. 110v power, plug-ins and extensions.

The LOC will NOT be providing power converters/transformers, waxing irons, vises, profiles, etc. However, both Swix and Toko will offer online shopping options for each delegation. The offering is summarized as follows:

- In late November 2022, the LOC sent each Delegation an invitation, instructions and custom access code for setting up their own Swix/Toko online shop for ordering discounted waxing and tuning equipment.
- Delegation or Team Managers must register and set up their team Swix/Toko website. Once properly registered, they are granted access to all Swix and Toko waxing and tuning supplies at special Lake Placid 2023 FISU Games pricing.
- The deadline for orders is 31 December 2022. All orders for each delegation will be shipped to a designated onsite location at the Northwood School campus in Lake Placid. Each team order will have the delegation's name and contact person on the package for easy identification.
- The Swix/Toko online shops will close 1 January 2023, giving us the necessary time to receive the products in Lake Placid and get them to the team waxing area locations.

#### **5.9 Doping Control**

Doping Control will be carried out in accordance with the WADA World Anti-Doping Code and FISU regulations. Conditions for doping control procedures will be provided during the competitions at all sports venues.

##### **5.9.1 LIST OF PROHIBITED SUBSTANCES**

The actual list of prohibited substances and methods is defined in accordance with WADA international standards. National University Sports Federations will be responsible for ensuring that their delegations, namely athletes, are made aware of the actual copy of the prohibited list. Ignorance of the prohibited list contents will in no way constitute a valid excuse for any participant of the Lake Placid 2023 FISU World University Games violating valid FISU Anti-Doping Rules. For the current WADA list of prohibited substances and methods, please refer to the following website: [www.wada-ama.org](http://www.wada-ama.org).

### 5.9.2 TESTING

The required number of samples will be selected during the “in-competition” and “out-of-competition” periods in accordance with the Test Distribution Plan. “In-competition” is defined as the period commencing 12 hours before a competition in which the athlete is scheduled to participate through to the end of such competition, and the sample collection process related to such competition. “Out-of-competition” is defined as any doping control which is not “in-competition.” During the Lake Placid 2023 FISU Games, athletes can be tested at any time without prior notice. Urine and/or blood samples will be collected in compliance with the WADA International Standard for Testing and Investigations (ISTI). A paperless system will be used for the sample collection. The testing will be conducted by Doping Control Officers (DCO) from the U.S. Anti-Doping Agency (USADA), an anti-doping organization accredited by WADA. Testing will be conducted under the supervision of the FISU International Medical Committee. Doping samples will be sent to the WADA-accredited anti-doping laboratory (LAD) in Montreal, Canada. All results will be sent to the Chairman of the FISU International Medical Committee and entered into the ADAMS system. In the event of a violation of FISU Anti-Doping rules, the responsibility of processing the results lies with the FISU International Medical Committee.

In the event of setting a national record, doping testing of the athlete is carried out at the expense of his/her National University Sports Federation.

### 5.9.3 DOPING CONTROL STATIONS

Doping control stations are located at each sports venue or in close proximity. The main doping control station is located in the Host City of Lake Placid. All doping control stations will be marked with signs, including signage directing athletes to the stations. After the completion of the doping control procedure, all samples collected at each doping control station will be delivered to the central doping control station together with the necessary support documentation (doping control protocols) for further registration in the ADAMS system. All samples will be packaged and sent to the WADA accredited anti-doping laboratory in accordance with international standards. All information concerning the doping control program during the Lake Placid 2023 FISU World University Games is confidential according to WADA and FISU requirements. When visiting a doping control station, athletes are required to have accreditation cards.

The doping control station for Alpine athletes will be located at the Whiteface Base Lodge, across from the Medical Services Area.

- Doping control stations for out of competition controls and outside venue operating hours will be allocated at medical stations in various locations, including Knowles Hall, Great Escape, Paul Smith’s College (the Health Center) and Lake Placid Sports Medicine. If testing outside of competition, athletes may be required to test at the medical station nearest them.

#### 5.9.4 THERAPEUTIC USE EXEMPTIONS (TUE)

Lake Placid 2023 FISU World University Games participants who require Therapeutic Use Exemptions (TUE) must make an appropriate request to their National Anti-Doping Organization or International Federation before participation in the Lake Placid 2023 FISU Games. The World Anti-Doping Agency International Standard for TUEs will be applied in this case. Every athlete who uses a substance or a method included in the list of prohibited substances is obliged to be in possession of a completed TUE form of the established standard from the moment of arrival until the departure from the Village after the Closing Ceremony of the Lake Placid 2023 FISU World University Games.

If there is a need for the use of a prohibited substance or a prohibited method for medical reasons after the opening of the Lake Placid 2023 FISU Games, an athlete must submit a request for TUE to the FISU International Medical Committee as a matter of urgency. The responsibility for completing the TUE form and submitting an application to the FISU International Medical Committee lies with the delegation physician.

If the delegation does not have its own physician, the athlete shall submit a request for TUE to the FISU International Medical Committee, with the attachment of medical documentation confirming the need for providing him/her with emergency medical treatment.

#### 5.9.5 STRUCTURE

Chair of FISU International Medical Committee	<b>Dr. Dusan Hamar</b>
OC Head of Medical Services & Doping Control	<b>Dr. Tracey Viola</b>

#### 5.10 Mascots and Medals

##### 5.10.1 MASCOT CEREMONY

Mascot Ceremonies will take place at the conclusion of each competition in the immediate vicinity of the Field of Play.

##### 5.10.2 MEDAL CEREMONY

- The Medal Ceremonies will be held at the Mid's Park – Medals Plaza according to the detailed day-by-day schedule (see Section 5.7).
- The official language for the Medal Ceremonies will be English.
- The medalists from each event must attend the Medal Ceremonies. In the event that a medalist is unable to attend, the medal is delivered to an official of the relevant delegation. He/she must be dressed in the delegation's official outfit. He/she must not mount the podium but stand behind it. The official awarding the medal will hand the medal and

mascot over the podium. During the FISU Anthem, the delegation official stands behind the podium.

- In the event all medalists cannot be present, the Medal Ceremony will be postponed.
- If an athlete or team is disqualified, the medal(s) shall be returned to FISU.

#### **During the Medal Ceremony:**

- The athletes are not allowed to bring any national flag or any other national, cultural or religious symbol on the podium.
- The national flags of the first three (3) medalists will be raised and the only anthem played will be the FISU Anthem, the Gaudeamus Igitur.
- During the playing of the FISU Anthem and the raising of the flags, athletes shall face the flags and always conduct themselves in a dignified manner. No national anthem is played during the ceremony.
- Athletes are expected to take off their caps and sunglasses when receiving their medal and keep items in hand throughout the ceremony (i.e., playing of the FISU Anthem and raising of the flags).
- Athletes, authorities and accompanying persons are required to face the flags while they are being raised and the FISU Anthem is being played.
- The medalists are expected to attend the ceremony in the uniforms they wore at the Opening Ceremony but are also allowed to attend the official ceremony wearing sport uniforms when the ceremony takes place immediately following the competition.
- After the medals are awarded, athletes must remain in the awarding area for photos on the podium with medals.
- In order to get the best photos, athletes should follow the recommendations of photographers.

#### **5.10.3 DIPLOMA OF HONOR**

- The athletes ranked one (1) to eight (8) will receive a Diploma of Honor.
- For team events, each team member, from teams ranked one (1) to six (6), will receive a personal Diploma of Honor mentioning his/her name and the team ranking.
- Diplomas of Honor are not distributed at the Medal Ceremony. They will be handed to the Head of Delegation or an appointed representative of each delegation prior to departure.
- If an athlete or team is disqualified, the diploma(s) shall be returned to FISU.

#### **5.11 Media Interviews**

Venue Media Centers for media representatives are organized at all Lake Placid 2023 FISU World University Games competition sites.

At the conclusion of a competition, all athletes must leave the Field of Play (FoP) through the mixed zone where brief interviews will be held. Every athlete/coach should be ready to communicate with media representatives upon their request. Team representatives should be

prepared to provide their athletes with a warm jacket or a blanket prior to entering the mixed zone.

A volunteer from the Venue Media Center will coordinate the exchanges between athletes/coaches and media. Support for translation in English will be provided during the mixed zone interviews. If an athlete/coach does not speak this language, they should invite their team interpreter to the mixed zone.

Media conferences are held at the beginning and the end of the Lake Placid 2023 FISU World University Games.

## 5.12 Sport Information Services

### 5.12.1 ONLINE SPORT INFORMATION SERVICES

Online information will be available on the Lake Placid 2023 FISU World University Games' official website: <https://www.lakeplacid2023.com/>

In addition, more detailed information and publications for teams can be accessed under the following link: <https://www.lakeplacid2023.com/><https://www.lakeplacid2023.com/delegation-services/publications/>

### 5.12.2 SPORT INFORMATION CENTER (SIC)

The Sport Information Center for Alpine Skiing is located at Northwood School in the main lobby.

The following services will be provided during the Lake Placid 2023 FISU World University Games:

- Competition schedule
- Training schedule
- Technical meeting information
- Distribution of daily sport results

The Sport Information Center will operate from 07:00 - 21:00 11-22 January 2023.

### 5.12.3 SPORT INFORMATION AT THE VENUE

A Sport Information Desk (SID) will be located at each venue, providing the most recent information related to the competitions and assisting the team representative(s) with sport-related questions.

- The Sport Information Desk will operate from 11 January 2023 until the last day of competition, in accordance with the competition and training schedules (one (1) hour before and after the events).



#### 5.12.4 SPORT INFORMATION DISTRIBUTION

Information	Online	Venue	SIC	ITO Hotel
Competition Schedule	+	+	+	+
Start List/ Result List	+	+	+	+
Change to Schedule	+	+	+	+
Special Announcements	+	+	+	+
Weather Information	+	+	+	+
Medal Table	+			
Technical Handbook	+			
FISU Regulations	+			
Other Information		+	+	+
Answer to Team Questions		+	+	+

## 6. SERVICE INFORMATION

### 6.1 Accreditation

Accreditation can be obtained by the HoD at the Welcome Center (Main Accreditation Center)

**Location:** Olympic Conference Center (Third (3<sup>rd</sup>) Floor)

2634 Main Street Lake Placid, NY 12946

Operating Dates: 7-23 January 2023

Operating Hours:

- 7-14 January, 09:00 – 21:00
- 15-23 January, 09:00 – 15:00

**IMPORTANT:** A personalized accreditation card with a photo, name and function of the cardholder carries information about the access rights and privileges available to him/her. Upon arrival, the accreditation card, equipped with a QR-code, enables members of delegations a 24-hour temporary access to the Lake Placid 2023 FISU World University Games venues in accordance with access rights on the accreditation card. The temporary access does not allow participation in the competition. After the CIC's approval, the accreditation card will be fully activated.

## 6.2 Radio Frequency Control

At all Lake Placid 2023 FISU World University Games venues, any use of frequencies (e.g., on walkie-talkies, radio stations, wireless cameras, Wi-Fi access points, wireless microphones, FM-transmitters and any other wireless equipment), will require a temporary radio license from the Organizing Committee (OC). All Delegations have been contacted separately regarding radio frequency license requests. If anyone has not received or responded to this communication, please contact [delegations@lakeplacid2023.com](mailto:delegations@lakeplacid2023.com) immediately.

Every wireless device must be registered by the frequency-organizer before it may be used.

- License-free\*: wireless microphones and in-ear monitoring systems, frequency range: 470-694 MHz
- License obligation: walkie-talkies (two (2)-way radio) and telemetry.

\* Only a limited number of shared frequencies are available. Registration is mandatory and such equipment will not have a dedicated channel.

## 6.3 Insurance and Responsibilities

Participating countries must adhere to the insurance requirements and conditions as stipulated in Section 5.6 of the FISU Games Winter General Regulations for the Lake Placid 2023 FISU World University Games.

Skiing and snowboarding off path:

Any participants skiing or snowboarding off the controlled slopes do so at their own risk. The Lake Placid 2023 FISU World University Games Organizing Committee does not accept any liability.

## 6.4 Transportation

### 6.4.1 TRANSPORTATION SYSTEM FOR ATHLETES AND TEAM OFFICIALS (TA)

The transportation system for athletes and team officials will provide transport services from 08-21 January 2023. Routes in the transportation system for athletes and official delegation members are marked with the abbreviation "TA" (Transport Athletes). Vehicles will be equipped with placards indicating route number for the individual and team sports and spectating athletes.

Route Number	TA NWS-WFM
Sport	Alpine Skiing
Route	Northwood School to Whiteface Mountain
Distance to the Venue	9.3 miles (15 km)
Time	15 min

## Transportation Service for Spectating Athletes and Officials

Scheduled buses are provided between Lake Placid and the competition venues for spectating athletes from 13-22 January 2023. Buses will operate in accordance with the competition schedule. All athletes and officials, regardless of their delegation and sport, will have access to the bus transportation system TS.

Detailed information will be available in the [Transportation Guide](#) for delegations.

## 6.5 Food and Beverages

Athlete dining will be at Northwood School's dining hall from 7-24 January 2023. The first meal will be provided on 7 January for lunch at 12:00. The last meal will be provided on 24 January until 10:30.

### 6.5.1 MEALTIMES

- Breakfast: 05:30-10:30
- Lunch: 11:00-16:00
- Dinner: 17:00-22:30
- Late Snack: 22:30-00:00

### 6.5.2 FNB SERVICES AT THE COMPETITION VENUES

- An athletes' lounge with meals will be provided one (1) hour prior to the competition until one (1) hour after the competition. This service is provided from the start of the first official training.
- Meals to be offered according to the schedule below.
  - 12 January: Lunch for Official Training of Men's & Women's Free Skiing and Super G
  - 13 January: Lunch for Men and Women's Super G
  - 14 January: Lunch for Women's Alpine Combine
  - 15 January: Lunch for Men's Alpine Combine
  - 17 January: Lunch for Women's Giant Slalom
  - 18 January: Lunch for Men's Giant Slalom
  - 19 January: Lunch for Men and Women's Mixed Team Parallel
  - 20 January: Lunch for Women's Slalom
  - 21 January: Lunch for Men's Slalom

## 6.6 Medical Services

### 6.6.1 CONDITIONS OF MEDICAL ASSISTANCE

- During the Lake Placid 2023 FISU World University Games, in the event of life-threatening diseases and conditions, emergency medical assistance in any situation is provided to all client groups.
- Immediate (except for emergency) and planned medical care is provided based on:
  - an obligatory medical insurance agreement;
  - a paid medical service agreement;
  - a voluntary health insurance agreement.

### 6.6.2 MEDICAL SUPPORT STRUCTURE

- Medical stations for athletes and spectators at the competition venues
- Mobile medical crews in the Field of Play of the competition venues
- Ambulance crews at the competition venues
- Dedicated hospitals and specialized medical facilities

### 6.6.3 MEDICAL SUPPORT IN THE ACCOMMODATION SITES

Medical services will be offered on site at Northwood School. Details can be found in the [Medical Services Guide](#).

### 6.6.4 DEDICATED HOSPITALS AND SPECIALIZED MEDICAL FACILITIES

- The Adirondack Medical Center is located at 203 Old Military Road, Lake Placid, NY 12946.
- Phone number: 518-523-3311

## 6.7 Weather and Climate

Lake Placid averages 102 inches (259 cm) of snow per year while the U.S. average is 28 inches (71.12 cm) of snow per year, with daily temperatures averaging 25°F to 1°F ( -3°C to -17°C).

Weather information can be picked up at Sport Information Centers at each of the Villages as well as online and at other locations, including on the Lake Placid 2023 FISU Games website.















## 7. OC CONTACTS

Title	Email
Accreditation	<a href="mailto:accreditation@lakeplacid2023.com">accreditation@lakeplacid2023.com</a>
Sport Entries	<a href="mailto:sportentries@lakeplacid2023.com">sportentries@lakeplacid2023.com</a>
Delegation Services	<a href="mailto:delegations@lakeplacid2023.com">delegations@lakeplacid2023.com</a>
ITO Service Desk	<a href="mailto:itoservices@lakeplacid2023.com">itoservices@lakeplacid2023.com</a>



## 8. APPENDICES

### 8.1 Lake Placid 2023 FISU World University Games Competition Schedule

VERSION 6 NOV 2022 *Subject to change All times are approximate		DAY 1 WED 11 January	DAY 2 THU 12 January	DAY 3 FRI 13 January	DAY 4 SAT 14 January	DAY 5 SUN 15 January	DAY 6 MON 16 January	DAY 7 TUE 17 January	DAY 8 WED 18 January	DAY 9 THU 19 January	DAY 10 FRI 20 January	DAY 11 SAT 21 January	DAY 12 SUN 22 January	MEDAL EVENTS
SNOW SPORTS	 CEREMONIES		Opening Ceremonies 19:00 - 20:30										Closing Ceremonies 19:30-20:00 Followed by Main Street Festivities	
	 ALPINE SKIING Whistler Mountain (W/M)		Official free-riding on Super-G course 10:00-12:00	Super-G W/M 10:00 - 11:30 W 13:00 - 15:00 M	Alpine Combined W 9:30 - 11:00 SG 13:00 - 14:00 SL	Alpine Combined M 9:30 - 11:00 SG 13:00 - 14:00 SL	Reserve Day	Giant Slalom W 9:30 - 11:00 1st run 12:30 - 14:00 2nd run	Giant Slalom M 9:30 - 11:30 1st run 13:00 - 15:00 2nd run	Mixed Team Parallel 11:00 - 13:00	Slalom W 9:30 - 11:00 1st run 12:30 - 14:00 2nd run	Slalom M 9:30 - 11:30 1st run 13:00 - 15:00 2nd run	Reserve Day	9
	 FREESTYLE & FREESKI Gore Mountain (G/M)				Official Training 10:00-12:00 9M Cross	Ski Cross W/M 10:30-12:30 OT 13:00-14:00 Qualifications	10:30-12:30 Round Robin Qualifications	Official Training 10:00-12:00 Slopestyle	Slopestyle W/M 10:00-12:00 Qualifications	Slopestyle W/M 10:00-11:30 Finals	Big Air W/M 10:00-12:00 Qualifications	Big Air W/M 10:00 - 12:00 Finals	Reserve Day	6
	 SNOWBOARD Gore Mountain (G/M)	Official Training 10:00-12:00 Snowboard Cross W/M	Snowboard Cross W/M 10:30-12:30 OT 13:00-14:00 Qualifications	Snowboard Cross W/M 10:30-13:00 Round Robin 13:30-14:00 Finals	Reserve Day	Official Training 13:00-15:00 Slopestyle M/W	Official Training 13:00-15:00 Slopestyle M/W	Slopestyle W/M 13:00-15:00 Qualifications	Slopestyle W/M 13:00-15:00 Finals	Big Air W/M 13:30 - 15:00 Qualifications	Big Air W/M 13:30 - 15:00 Finals	Parallel Giant Slalom W/M 10:00 - 11:00 Qualifications	Parallel Slalom W/M 10:00 - 11:00 Qualifications	10
	 BIATHLON Mt. Van Hoevenberg (M/W)	Open Training 11:00-13:00	Open Training 11:00-13:00	Official Training 12:15-14:00 M 14:15-16:00 W	Individual M/W 11:15-12:05 Zoning M 12:15-13:30 15km M 13:45-14:35 Zoning W 14:45-16:00 12.5km W	Official Training 12:45-14:30 M/W	Single Mixed Relay 13:15-13:45 Zoning M/W 14:00-14:50 4km W+1.5km M	Official Training 13:00-14:30 M 15:00-16:30 W	Sprint M/W 12:00 - 12:50 Zoning M 13:00 - 14:15 15km M 14:30 - 15:10 Zoning W 15:20 - 16:35 7.5 km W	Pursuit M/W 13:00 - 13:30 Zoning M 13:40 - 14:25 12.5km M 14:40 - 15:10 Zoning W 15:20 - 16:05 10km W	Official Training 14:00 - 15:00 M 15:00 - 16:00 W	Mass Start M/W 13:00 - 13:30 Zoning M 13:40 - 14:30 15 km M 14:45 - 15:15 Zoning W 15:35 - 16:10 12.5 km W	Reserve Day	9
	 CROSS-COUNTRY SKIING Mt. Van Hoevenberg (M/W)	Open Training 9:00-11:00	Official Training 9:00-11:00	Mixed Team Sprint [C] 8:00-8:55 Training 9:00-10:00 Semifinals 10:00-10:30 Finals	Official Training 9:00-11:00	Sprint W/M [F] 8:00-8:55 Training W 9:00-9:55 Qualifications W/M 11:00-12:30 Finals W/M	Official Training 9:00-11:30	Individual W/M [C] 8:00-8:55 Training W 9:00-10:00 Sem W 10:00-10:25 Training M 10:30 - 12:00 10km M	Pursuit W/M [F] 8:00-8:55 Training W 9:00-9:55 Sem W 9:30-10:10 Training M 10:15-11:00 10km M	Official Training 9:00-11:00	Relay W/M 8:00-8:55 Training W 9:00-10:00 3x5km W [C/F] 10:05-10:55 Training M 11:00-12:45 4x7.5km M [C/F]	Official Training 9:00-12:00	Mass Start M/W 9:00-9:55 Training M 10:00-12:00 30km M [F] 12:00-12:55 Training W 13:00-14:00 15km W [F]	11
	 NORDIC COMBINED Olympic Jumping Complex (G/C) Mt. Van Hoevenberg (M/W)	Official Training 13:00-15:30 S/P-2 18:00-19:30 CCS	Official Training Ind. Gundersen W/M 10:00-11:30 S/P-2 12:00-13:00 PCR 14:00-15:00 CCS	Individual Gundersen W/M 13:00-13:30 S/P Trial W/M 14:00-14:30 S/P-1 W/M 17:30-17:55 CCS OT M/W	Official Training 13:00-14:30 S/P-2 16:15-17:00 CCS	Mass Start W/M 15:00-15:20 CCS 5km W 16:00-16:40 CCS 10km M 19:00-19:30 S/P Trial W/M 20:00-20:30 S/P-1 W/M	Official Training 13:00-14:30 S/P-2 17:00-17:55 CCS	Team Sprint W/M 12:00-12:30 S/P Trial W/M 14:00-14:30 S/P-1 W/M 18:00-18:30 CCS 2x (1.5x1.5km)	Mixed Team Nordic 12:00-12:45 S/P Trial 13:00-13:45 S/P-1 18:00 - 18:40 CCS 2x2.5km	Reserve Day	Reserve Day	Team NH W/M 16:45-17:00 W Trial 17:30-18:20 W 19:00-19:30 M Trial 20:00-21:30 M	7	
	 SKI JUMPING Olympic Jumping Complex (G/C)			Official Training 17:30-18:45 W (x3) 19:00-20:45 M (x3)	Official Training 11:00-12:15 W (x3) 12:30-14:15 M (x3)	Official Training 16:00-16:15 W Trial 17:00 - 18:00 W (x2) 19:00-19:30 M Trial 20:00-21:30 M (x2)	Official Training 17:00-20:00 (x3) 18:00-19:30 Mixed Relay	Mixed Team NH 17:00-17:30 Trial 18:00-19:30 Mixed Relay	Official Training 18:00-21:00 W/M (x3)	Reserve Day	Reserve Day	Reserve Day	8	
ICE SPORTS	 CURLING Sarcelle Lake Club Center (SUK) Women (USA, CAN, GBR, JPN, KOR, SLO, SWE, AUS, CHN, CZE) Men (USA, CAN, GBR, JPN, KOR, SLO, SWE, RUS, CZE, NOR)		Official Training 8:30-15:45	14:00-16:15 W1 19:00-21:15 M1	9:00-11:15 W2 14:00-16:15 M2 19:00-21:15 W3	9:00-11:15 M3 14:00-16:15 W4 19:00-21:15 M4	9:00-11:15 W5 14:00-16:15 M5 19:00-21:15 W6	9:00-11:15 M6 14:00-16:15 W7 19:00-21:15 M7	9:00-11:15 W8 14:00-16:15 M8 19:00-21:15 W9	9:00-11:15 M9 14:00-16:15 SF W 19:00-21:15 SF M	14:00-16:15 Bronze W 19:00-21:15 Bronze M	14:00-16:15 Gold W 19:00-21:15 Gold M		2
	 FIGURE SKATING Olympic Center (O/CN)	Official Training 8:00-16:40	Official Training 7:00-15:40	Ice Dance 13:00-15:10 Rhythm Dance Men 17:00-22:00 Short Dance Women 19:00-22:30 Free Dance	Women 13:00-18:10 Short Program Ice Dance Men 20:00-22:15 USA-KOR	Men 13:00-16:50 Free Skating Women 19:00-22:50 Free Skating	Exhibition Gala 14:00-15:30							3
	 ICE HOCKEY (MEN) Q: Chase Arena (CHN) Q: Ross House (RUS) Q: Henry Hall (USA) SF & F: Olympic Center (O/CN)	13:00-15:15 HUN-SVK (1) 16:30-18:45 JPN-LAT (2) 20:00-22:15 GBR-USA (3)	9:30-11:45 SWE-CZE (4) 13:00-15:15 KOR-KAZ (5) 16:30-18:45 USA-KOR (6)	9:30-11:45 KAZ-HUN (7) 13:00-15:15 CAN-SWE (8) 16:30-18:45 CZE-JPN (9) 20:00-22:15 SVK-CAN (10)	13:00-15:15 LAT-UKR (11) 20:00-22:15 USA-KOR (12)	9:30-11:45 CAN-JPN (13) 13:00-15:15 CZE-LAT (14) 16:30-18:45 SVK-USA (15) 20:00-22:15 KAZ-GBR (16)	13:00-15:15 KOR-HUN (17) 16:30-18:45 KAZ-SVK (18) 20:00-22:15 UKR-SWE (19)	9:30-11:45 HUN-GBR (20) 13:00-15:15 SVK-KOR (21) 16:30-18:45 CAN-CZE (22) 20:00-22:15 JPN-UKR (23)	9:30-11:45 USA-KAZ (23) 13:00-15:15 SVK-KOR (24) 16:30-18:45 CAN-CZE (25) 20:00-22:15 JPN-UKR (26)	9:30-11:45 USA-HUN (27) 13:00-15:15 GBR-KOR (28) 16:30-18:45 CAN-SWE (29) 20:00-22:15 CZE-UKR (30)		9:35-12:00 Semifinal 1 (31) 13:05-15:30 Semifinal 2 (32)	11:05-13:30 Bronze (33) 17:10-19:30 Gold (34)	1
	 ICE HOCKEY (WOMEN) Q: Henry Hall (USA) SF & F: Olympic Center (O/CN)	16:30-18:45 GBR-CZE (1) 20:00-22:15 SVK-CAN (2)	13:00-15:15 USA-JPN (3)	16:30-18:45 JPN-SVK (4) 20:00-22:15 CZE-USA (5)	16:30-18:45 CZE-CAN (6) 20:00-22:15 GBR-SVK (7)	16:30-18:45 CAN-JPN (8) 20:00-22:15 USA-GBR (9)	16:30-18:45 USA-SVK (10) 20:00-22:15 JPN-CZE (11)	16:30-18:45 CAN-GBR (12) 20:00-22:15 SVK-CZE (13)			14:35-17:05 Semifinal 1 (14) 20:05-22:30 Semifinal 2 (15)	17:05-19:30 Bronze (16) 20:35-23:00 Gold (19)		1
	 SHORT TRACK SPEED SKATING Olympic Center (O/CN)						Unofficial Training 9:00-17:00	Unofficial Training 9:00-17:00	Official Training 8:00-16:00	1500m W/M 16:00-18:30 2000m Mixed Team Relay 19:30-20:30 Q	500m W/M 16:00-18:30 3000m W/5000m M Relay 19:00-19:50 Q 2000m Mixed Team Relay 20:10-20:40 Final	1000m W/M 16:00-19:00 3000m W/5000m M Relay 19:30-20:30 Final		9
	 SPEED SKATING Olympic Center Oval (O/CN)		Unofficial Training 10:30-16:30	Official Training 10:30-16:30	Official Training 10:30-16:30	1000m W/M 10:00-11:40	3000m W/5000m M 10:00-12:35	1500m W/M 10:00-11:30	Team Pursuit W/M 10:00-11:30	500m W/M Mixed Team Relay 10:00-12:30	Mass Start W/M 10:00-11:05	Reserve Day		13
MEDAL CEREMONIES				7	4	9	7	7	12	9	14	12	5	86

## 8.2 Venue Layouts

### 8.2.1 VENUE PLANS

WFM  
ALP

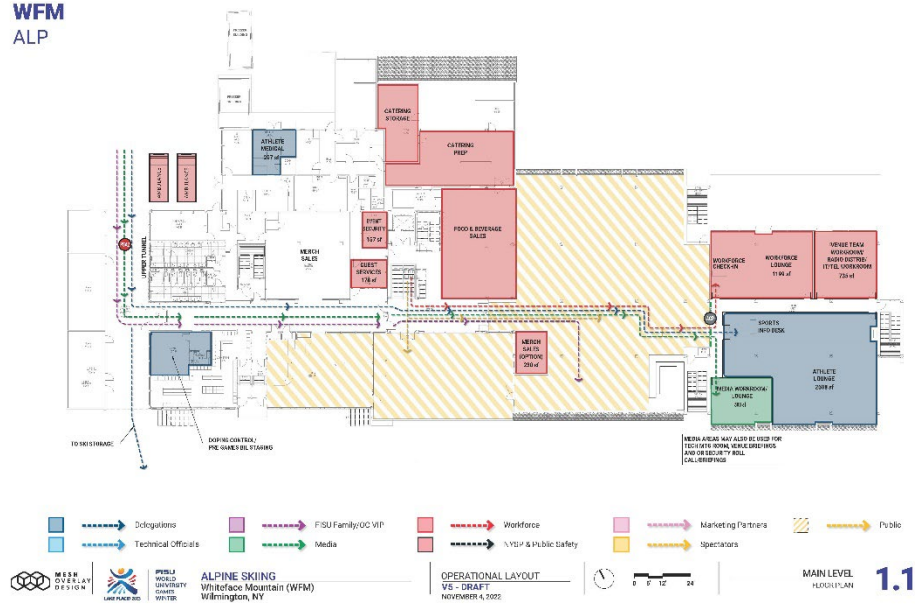

WFM  
ALP

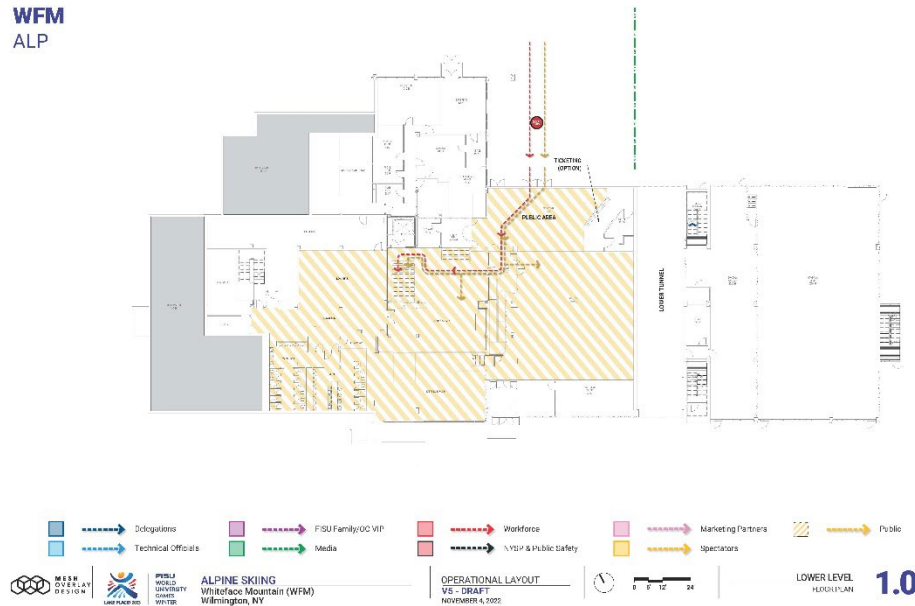

## WFM ALP

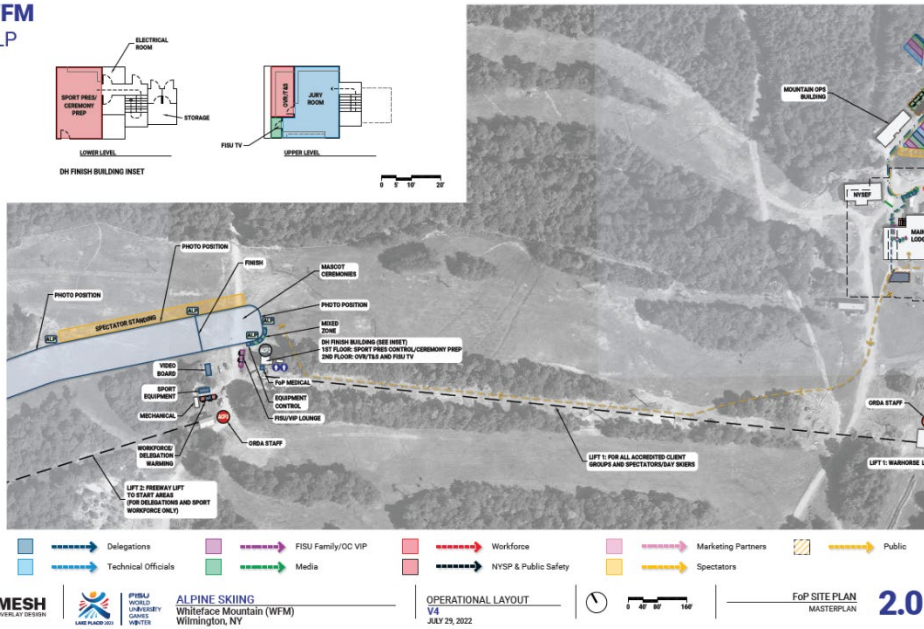

### 8.2.2 OVERVIEW SLOPES

#### WHITEFACE MOUNTAIN

#### UPPER THRUWAY/DRAPERS GS

	M	M/W	M/W	M/W
Start	897m	830m	765m	897m
Finish	467m	467m	467m	497m
VD	430m	363m	298m	400m
Length	1,420m	1,280m	1,133m	1,220m
Avg Grad	30%	28%	27%	32%
Max Grad	48%	47%	44%	44%
Min Grad	7%	7%	7%	14%

## WHITEFACE MOUNTAIN

### UPPER THRUWAY/DRAPERS SG

M/W	
Start	938m
Finish	467m
VD	471m
Length	1,490m
Avg Grad	30%
Max Grad	48%
Min Grad	7%

## WHITEFACE MOUNTAIN

### DRAPER'S DROP SL

	M/W	M/W
Start	688m	655m
Finish	488m	467m
VD	200m	188m
Length	711	723m
Avg Grad	28%	28%
Max Grad	44%	44%
Min Grad	14%	7%







WFM  
ALP

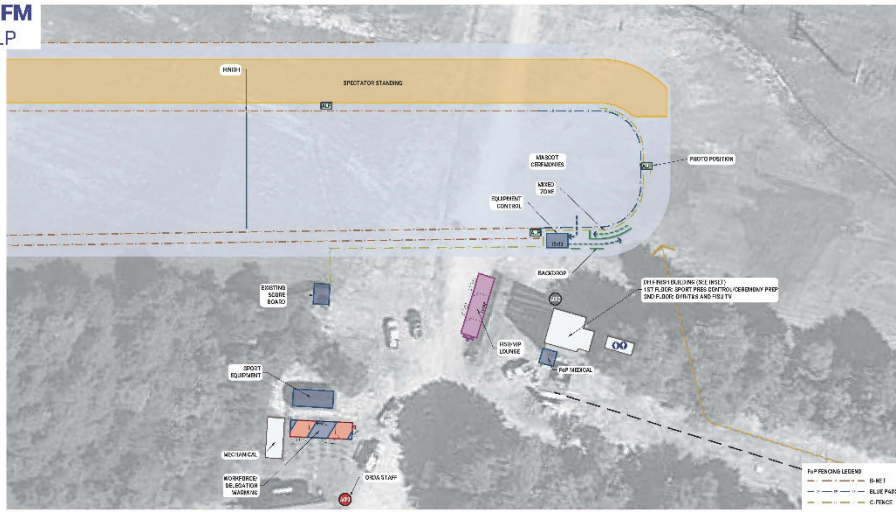

WFM  
ALP

ALPINE SKIING  
Whiteface Mountain (WFM)  
Wilmington, NY

OPERATIONAL LAYOUT  
V5 - DRAFT  
NOVEMBER 4, 2022

For FINISH PLAN  
MASH PLAN  
2.2

## 8.3 Geographical Overview Venues

WFM  
ALP

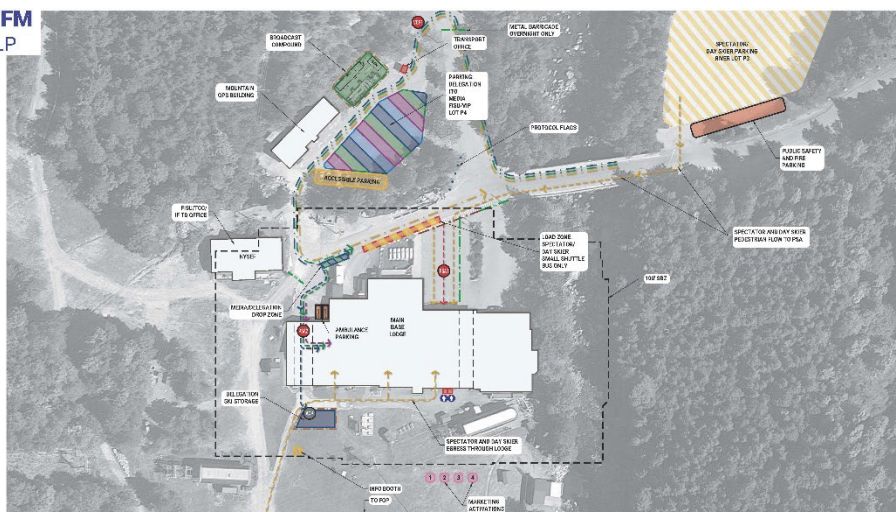

WFM  
ALP

ALPINE SKIING  
Whiteface Mountain (WFM)  
Wilmington, NY

OPERATIONAL LAYOUT  
V5 - DRAFT  
NOVEMBER 4, 2022

LODGE SITE PLAN  
MASH PLAN  
0.2





**FISU**  
WORLD  
UNIVERSITY  
GAMES  
WINTER