



FISU
WORLD
UNIVERSITY
GAMES
WINTER

TECHNICAL HANDBOOK

ICE HOCKEY

December 2022

TABLE OF CONTENTS

1. Welcome Messages	5
2. Abbreviations	8
3. FISU International Technical Committee	9
4. General Information	10
4.1 Lake Placid 2023 FISU World University Games	10
4.2 Competition Schedule	10
4.3 Opening and Closing Ceremonies	10
5. Competition Information	11
5.1 Technical Committee	11
5.2 International Technical Officials	11
5.3 Competition Structural Chart	12
5.4 Technical Regulations	13
5.4.1 Protest and Appeal	13
5.5 Competition Format	14
5.5.1 Entries	14
5.5.2 Number of Players on the Line-Up Sheet	14
5.5.3 Tournament Format	15
5.5.4 Three-Point System (IIHF Sport Regulations)	15
5.5.5 Tie Breaking System (IIHF Sport Regulations)	16
5.5.6 Overtime Operations (IIHF Sport Regulations)	17
5.5.7 Penalty-Shot Shootout Procedure (IIHF Sport Regulations)	19
5.6 Competition and Training Venue Information	20
5.6.1 General Information	20
5.6.2 Venue Layouts	21
5.7 Day by Day Schedule	21
5.7.1 Training	34
5.7.2 General Technical Meetings	34
5.8 Equipment	34
5.9 Doping Control	35
5.9.1 List of Prohibited Substances	35

5.9.2 Testing.....	35
5.9.3 Doping Control Stations	36
5.9.4 Therapeutic Use Exemptions (TUE)	36
5.9.5 Structure	37
5.10 Mascots and Medals	37
5.10.1 Mascot Ceremony.....	37
5.10.2 Medal Ceremony.....	37
5.10.3 Diploma of Honor.....	38
5.10.4 Diploma of Merit.....	38
5.11 Media Interviews	38
5.12 Sport Information Services	39
5.12.1 Online Sport Information Services	39
5.12.2 Sport Information Center (SIC)	39
5.12.3 Sport Information at the Venue.....	39
5.12.4 Sport Information Distribution	40
6. Service Information.....	40
6.1 Team Services	40
6.1.1 Team Service Office	40
6.1.2 Team Sport Attaché	40
6.1.3 Dressing Rooms.....	41
6.1.4 Skate Sharpening & Equipment Repair.....	41
6.1.5 Laundry Service.....	41
6.1.6 Towels	42
6.1.7 Penalty Box.....	42
6.1.8 Fitness Room and Bikes	42
6.1.9 Other Arena Services	42
6.1.10 Pucks	42
6.1.11 Ice Practices - Cancellation	43
6.1.12 OC Contact Info.....	43
6.2 Accreditation.....	43
6.3 Radio Frequency Control	43

6.4 Insurance and Responsibilities.....	44
6.5 Transportation	44
6.5.1 Transportation System for Athletes and Team Officials (TA)	44
6.6 Food and Beverages.....	46
6.6.1 Mealtimes	46
6.6.2 FNB Services at the Competition Venues	46
6.7 Medical Services.....	46
6.7.1 Conditions of Medical Assistance	46
6.7.2 Medical Support Structure.....	47
6.7.3 Medical Support in the Accommodation Sites	47
6.7.4 Dedicated Hospitals and Specialized Medical Facilities.....	47
6.8 Weather and Climate	47
7. OC Contacts.....	47
8. Appendices.....	48
8.1 Lake Placid 2023 FISU World University Games Competition Schedule.....	48
8.2 M and W Ice Hockey Detailed Schedule	48
8.3 Playoff Team Transportation Plans.....	50
8.4 Venue Layouts.....	50
8.5 Geographical Overview Venues.....	52

1. Welcome Messages

*Dear Delegates,
Dear Friends and Colleagues,*

Thank you for your participation in the Lake Placid 2023 FISU World University Games. I would like to recognize the Organizing Committee and FISU for their hard work and dedication—without them, this event would not be possible. The past months have been very important as we put together the final touches to welcome the world's best collegiate-athletes to participate in these FISU Games.

The recent HoD meeting was very successful and as we get closer to the Lake Placid 2023 FISU Games it becomes even more exciting to call Lake Placid a two-time host, since they held the FISU Games in 1972. It is obvious that international events come naturally to the region, therefore, we are confident that Lake Placid is ready to welcome the world's best collegiate-athletes to their stage once again.

We would like to thank each and every one of you for your participation and hope you will spend the next 11 days discovering what this beautiful village in New York State and Adirondack Region has to offer. We are excited to see the result of your hard work and dedication that has gone into the preparation for these Games and are looking forward to having you with us in Lake Placid.

I wish you all good luck and hope you have a great stay in Lake Placid!

Thank you.



*Leonz Eder
Acting President of the
International University Sports Federation*

Dear Technical Delegates and Officials,

I look forward to welcoming you to Lake Placid, NY and the surrounding North Country region, where the Lake Placid 2023 FISU World University Games will soon be underway. It is a privilege and honor to once again the host the World in our historic village!

As a community known for its rich sporting history, Lake Placid is proudly home to the 1932 and 1980 Olympic Winter Games, the 1972 FISU World University Games and countless World Cup and World Championship events. In preparation for the upcoming Lake Placid 2023 FISU Games, the venues have undergone extensive modernizations to provide world class facilities for decades to come, ensuring the continuation of our sporting legacy.

I am pleased to welcome you to my hometown and the surrounding North Country region. This technical handbook is intended to provide you with all the information you need to guide you through your time here. I wish each of the participating collegiate-athletes success and hope everyone leaves with unforgettable memories that are shared for years to come!

Sincerely,



Ashley Walden
Chief Operating Officer of the
Lake Placid 2023 FISU World University Games

Dear Delegations,

Welcome to the Lake Placid 2023 FISU World University Games! Lake Placid, our Adirondack Region and the State of New York thank you for your dedication to University sport and we welcome you to our home with open arms.

As hosts of the 1972 FISU World University Games, we are excited to continue Lake Placid's legacy as a global center of international sport by again welcoming collegiate-athletes from across the globe.

The Organizing Committee recognizes our duty to support collegiate-athletes in their efforts to achieve excellence in their chosen disciplines by providing top-of-the-line competition venues and an unforgettable experience. With this in mind, we have worked to ensure that all participants have an opportunity to showcase their talents as they compete with cooperation and respect for one another.

Enjoy competition, enjoy our village, our region and our state so that you may leave Lake Placid with added and renewed feelings about the positive benefits of international University sport.

Please reach out to us as you may wish.

With all good wishes,



*James B. McKenna
President of the
Lake Placid 2023 FISU World University Games*

2. ABBREVIATIONS

Abbreviation	Name in Full
ADAMS	Anti-Doping Administration and Management System
CHA	Cheel Arena
CIC	FISU International Control Committee
CMI	FISU International Medical Committee
CPH	Crowne Plaza Hotel
CT	FISU Technical Committee
EC	FISU Executive Committee
FISU	International University Sports Federation
FNB	Food & Beverage
GTM	General Technical Meeting
HoD	Head of Delegation
IF	International Federation
IHO	Ice Hockey
IIHF	International Ice Hockey Federation
ITC	FISU World University Games International Technical Committee
ITO	International Technical Official
LOC	Local Organizing Committee
MAH	Maxcy Hall
NADO	National Anti-Doping Organization
NF	National Federation
NTO	National Technical Official
NUSF	National University Sports Federation
OC	Organizing Committee

OCN	Olympic Center
ROH	Roos House
SIC	Sports Information Center
SID	Sports Information Desk
TD	Technical Delegate
TCC	FISU Technical Committee Chair
TO	Technical Official
TUE	Therapeutic Use Exemptions
VW	Knowles Hall
WADA	World Anti-Doping Agency

3. FISU INTERNATIONAL TECHNICAL COMMITTEE

Position	First Name	Last Name	Country
FISU TCC ALP	Matjaz	Kranjc	SLO
FISU TCC BTH	Ondrej	Rybar	CZE
FISU TCC CCS	Zofia Stefania	Kielpinska	POL
FISU TCC NCB	Karl	Lustenberger	SUI
FISU TCC SJP	Paul	Ganzenhuber	AUT
FISU TCC FRS	Magnus	Ferry	SWE
FISU TCC SBD	Ola	Sundekvist	SWE
FISU TCC CUR	Scott	Arnold	CAN
FISU TCC IHO	Reto	Bertolotti	SUI
FISU TCC IHO	Igor	Nemecek	SVK
FISU TCC FSK	Dingding	Liu	CHN
FISU TCC STK	So Hee	Kim	KOR
FISU TCC SSK	Moyca	Stoffel	CAN

4. GENERAL INFORMATION

4.1 Lake Placid 2023 FISU World University Games

Date: 12- 22 January 2023

Location: Lake Placid, New York

Sports Program: 12 sports, 86 Medal Events

Venues: 9 venues

4.2 Competition Schedule



4.3 Opening and Closing Ceremonies

Opening Ceremony

Date: 12 January 2023

Location: Olympic Center, 1980 Herb Brooks Arena

Beginning of Ceremony: 19:00

Closing Ceremony

Date: 22 January 2023

Location: Olympic Center, 1980 Herb Brooks Arena

Beginning of Ceremony: 17:10

5. COMPETITION INFORMATION

5.1 Technical Committee

Technical Committee Chairs	Igor Nemecek (SVK) Reto Bertolotti (SUI)
IIHF Medical Supervisor	Jaan Molder (EST)
Sport Manager	Dave Webb (USA)

5.2 International Technical Officials

IIHF Supervisors (Men)	Peter Orszag (SVK) Todd Anderson (CAN)
Referees (Men)	Maris Locans (LAT) Jae Hyung Park (KOR) Goro Terakado (JPN) Johan Wedin (SWE) Gergely Korbulu (HUN) Walker Holton (USA) Marek Zak (SVK) Mikhail Stupak (KAZ) Loïc Ruprecht (SUI)
Linesmen (Men)	Renars Davidonis (LAT) Do Yeon Choi (KOR) Go Hashimoto (JPN) Tatsuki Watanabe (JPN) David Szabo (HUN) Bryan Gorcoff (USA) Peter Jedlicka (SVK) Vladislav Zotov (KAZ) Dominik Schlegel (SUI)
IIHF Supervisor (Women)	Stacey Livingston (USA)

Referees (Women)	Agnese Karklina (LAT) Bo Young Choi (KOR) Miyuki Nakayama (JPN) Mariko Dale (SUI) Svenja Strohmeier (GER) Amy Martin (CAN) Charlotte Hurley (USA)
Linesmen (Women)	Rylie Lissebeck (USA) Alexandra Köhl (SWE) Adrienn Paulheim (HUN) Zora Gottlibet (HUN) Abigail Torres (USA) Eva Maria Molekova (SVK) Michèle Müller (SUI)

5.3 Competition Structural Chart

Venue Manager		FISU TCCs
Logan Norris (CHA)		Reto Bertolotti Igor Nemecek
Keenan O’Gorman (MAH)		IIHF TDs
Lake Kwaza (OCN)		Igor Nemecek
Francesco Palumbo (ROS)		IIHF Medical Supervisor Jaan Molder
Security	Sport Manager	Workforce/Volunteers
Michael Ryan	Dave Webb	Bethany Valenze

5.4 Technical Regulations

The Ice Hockey events shall be organized in accordance with the most recent regulations of the International Ice Hockey Federation (IIHF), except when specifically amended by these regulations or by the FISU Games International Technical Committee (FISU Games ITC).

The program and duration of the competitions will be fixed by the Executive Committee in agreement with Lake Placid 2023 and the FISU Games ITC. In principle, the competitions will last 12 days maximum and will include:

Men	Women
12-team tournament	6-team tournament

Each country is authorized to enter a men's team and/or a women's team composed of a minimum of fifteen (15) players and two (2) goalkeepers, and a maximum of twenty (20) players and three (3) goalkeepers.

At the first General Technical Meeting, the Head of Delegation or his/her representative shall confirm and sign the official list of competitors.

Once the Head of Delegation/coach signs the list (roster) of players and goalkeepers, no change (replacements or additions) is permitted.

Only with an accreditation card approved by the FISU International Control Committee (CIC) can an athlete be considered for the roster and be entitled to participate in any of the games.

No player or team official under a current suspension from FISU, IIHF or the National Federation of his/her country may take part in the tournament.

On ice officiating system: "Four-man officiating system" (two referees and two linesmen). FISU Technical Committee Chairs may, at their sole discretion, apply the one-referee and two-linesmen system for games in the round robin.

5.4.1 PROTEST AND APPEAL

- Any protest of a sport or disciplinary nature must reach the Jury or other proper authority according to the regulations laid down by the IIHF. Such protest must be accompanied by a deposit, the amount of which is set in line with the IF regulations, if not otherwise specified in the technical regulations of concerned sport.
- Each Head of Delegation or his/her deputies are authorized to lodge an appeal against the decision of the Jury. This appeal must be submitted in writing to the Jury of Appeal or proper authority in accordance with the IIHF regulations.
- Any sport disciplinary situation which cannot be satisfactorily resolved by the Sport Technical Committee (TC) and the sport specific disciplinary regulations will be reported to

the FISU Disciplinary Committee for further action to be taken. Where appropriate, a report will be sent to IIHF.

5.5 Competition Format

5.5.1 ENTRIES

Men

Twelve countries have qualified to enter teams and participate in accordance with FISU Lake Placid 2023 Regulations. Teams have been placed in two (2) groups based on FISU ranking.

Group A	Group B
CAN	KAZ
CZE	SVK
LAT	USA
SWE	HUN
JPN	GBR
UKR	KOR

Women

Six countries have qualified to enter teams and participate in accordance with FISU Lake Placid 2023 Regulations. The teams are in one group and will play a Round Robin.

Group A
CAN
USA
JPN
GBR
SVK
CZE

5.5.2 NUMBER OF PLAYERS ON THE LINE-UP SHEET

- 60 minutes before the start of the game, a representative from each team must provide the scorekeeper with a line-up (list of names and corresponding jersey numbers for the players dressing), including the names of the captain(s) and alternate captain(s).
- Each team is allowed to dress a maximum of 20 skaters and 2 goaltenders for a game.
- Only eligible players are allowed to be listed on the line-up sheet and play in the game.
- If, during the course of a game, both goaltenders from a team are unable to play, the team will be allowed to dress a skater from the players' bench to play as a goaltender.
- The skater has 10 minutes to dress and be ready to play, but if he/she is ready before the 10-minute mark, he/she is allowed to use the remaining time for an on-ice warmup.

- With the exception of a third (3rd) goaltender, no alterations to the line-up are allowed once the game has started.

5.5.3 TOURNAMENT FORMAT

MEN

The format of the Men's Tournament comprises:

- PRELIMINARY ROUND played in two groups (30 games), from which 4 teams will qualify to the semi-finals.
- SEMI-FINAL ROUND (2 games)
- MEDAL ROUND (2 games) – Bronze Medal Game and Gold Medal Game

A game consists of three periods of 20 minutes (with two intermissions above 15 minutes, if not otherwise decided in the directorate) plus overtime and a penalty-shot shootout if required.

WOMEN

The format of the Women's Tournament comprises:

- PRELIMINARY ROUND played in one (1) group (15 games), from which four (4) teams will qualify for the semi-finals.
- SEMIFINAL ROUND (two (2) games)
- MEDAL ROUND (two (2) games) – Bronze Medal Game and Gold Medal Game.
- During the PRELIMINARY ROUND the teams will play a Round Robin. The four (4) highest-ranking teams from the group will qualify for the SEMIFINALS. The SEMIFINAL ROUND will be played as follows:
 - 1st place vs. 4th place
 - 2nd place vs. 3rd place

The two (2) winning teams will play in the Gold Medal Game and the two (2) losing teams will play in the Bronze Medal Game.

5.5.4 THREE-POINT SYSTEM (IIHF SPORT REGULATIONS)

For all games, points shall be awarded as follows:

- Three (3) points for the winning team at the conclusion of regulation time.
- One (1) point for both teams at the conclusion of regulation time if the game is tied.
- An additional point earned for the team that wins the game in a 5-minute overtime period, or the penalty-shot shootout if the teams are still tied following conclusion of the overtime period.
- Zero (0) points for the team that lost the game at the conclusion of regulation time.

5.5.5 TIE BREAKING SYSTEM (IIHF SPORT REGULATIONS)

The tie-breaking system for two (2) teams with the same number of points in a standing will be the winner of the game played between the two (2) teams. The winner of that game will receive the higher ranking.

Due to the fact that the three (3)-point system does not allow a game to end in a tie, the following tie breaking procedure is applicable when three (3) or more teams are tied in points in a championship standing.

Should three (3) or more teams be tied in points, then a tie breaking formula will be applied as follows: creating a sub-group amongst the tied teams. This process will continue until only two (2) or none of the teams remain tied. In the event of two (2) remaining tied teams, the game between the teams would then be the determining tiebreaker, as the game could not end as a tie. FISU special regulations: in any event when the goal difference will be decisive, only a 10-goal difference per game will be taken into account.

Step 1:

Taking the games between each of the tied teams into consideration, a sub-group is created, applying the points awarded in the direct games amongst the tied teams, from which the teams are then ranked accordingly.

Step 2:

Should three (3) or more teams still remain tied in points, the highest goal differential in the direct games amongst the tied teams will rank the highest.

Step 3:

Should three (3) or more teams still remain tied in points and goal difference, then the highest number of goals scored by these teams in their direct games will determine the ranking.

Step 4:

Should three (3) or more teams still remain tied in points, goal difference and goals scored, the results between each of the teams and the closest, highest-ranked team outside the subgroup will be applied. In this case, the tied team with the best result (1. points, 2. goal difference, 3. more goals scored) against the closest, highest-ranked team will take precedence.

Step 5:

Should the teams still remain tied, then the results between each of the three (3) teams and the next highest-ranked team outside the sub-group will be applied.

Step 6:

Should the teams still remain tied after these five (5) steps have been exercised, sport considerations will be applied, and the teams will be ranked by their positions coming into the Championship (i.e., seeding).

The IIHF Tie Breaking System will be used to resolve ties before the end of the Preliminary Round.

In the event where two (2) teams are tied and they have not yet played against each other, and in the event where three (3) or more teams are tied and not all mutual games have been played within the sub-group, the following criteria will be used to break the tie:

1. Fewest number of games played
2. Highest goal differential (GF-GA) in all games
3. Highest number of goals for (GF) in all games
4. Highest tournament seeding entering the tournament

In the event of three (3) or more tied teams, this process will continue until only two (2) teams remain tied. The game between the two (2) remaining tied teams would then be the determining tiebreaker. If the two (2) remaining tied teams have not played each other, the tie break will be determined by re-starting the process only for these two (2) teams.

5.5.6 OVERTIME OPERATIONS (IIHF SPORT REGULATIONS)

Overtime – Operations for a Round Robin or for a Preliminary Round Game

If, at the end of the three (3) 20-minute periods in a single Round Robin championship or the Preliminary Round of a top category championship, the two (2) teams playing are tied, the teams will then play a 'sudden death' overtime period of five (5) minutes. The team that scores first will be declared the winner. The overtime period shall be played with each team at a numerical strength of three (3) skaters and one (1) goaltender. The overtime period will commence following a three (3)-minute intermission.

Once the intermission has been completed, the clock will be reset to five (5) minutes and the overtime period will begin immediately. Teams will not change ends. The players will remain on their respective benches during the three (3)-minute intermission. Goaltenders must go to their respective benches during this rest period; however, penalized players must remain in the penalty box.

Should a penalized player exit the penalty box, he/she shall be returned immediately by the game officials with no additional penalty being assessed, unless he/she commits an infraction of any other rule. Teams are not permitted to return to the dressing room during this time.

Penalties

If regulation time ends and the teams are 5 on 3, teams will start the overtime period 5 on 3. Once player strength reaches 5 on 4 or 5 on 5, at the next stoppage of play, player strength is adjusted to 4 on 3 or 3 on 3, as appropriate. If regulation time ends and teams are 4 on 4, teams will start the overtime period 3 on 3.

Once player strength reaches 4 on 4, at the next stoppage of play, player strength is adjusted to 3 on 3. If, at the end of regulation time, teams are 3 on 3, overtime starts 3 on 3. Once player strength reaches 4 on 4, 5 on 4 or 5 on 5, at the next stoppage, player strength is adjusted to 3 on 3 or 4 on 3, as appropriate. At no time will a team have less than three (3) players on the ice. This may require a fourth (4th) and/or fifth (5th) skater to be added in the event that penalties are assessed. If a team is penalized in overtime, teams play 4 on 3. If both teams are penalized with minor penalties at the same stoppage of play (with no other penalties in effect), teams will continue to play 3 on 3.

In overtime, if a team is penalized such that a two (2)-man advantage is called for, then the offending team will remain at three (3) skaters while the non-offending team will be permitted five (5) skaters. At the first stoppage of play after the two (2)-man advantage is no longer in effect, the numerical strength of the teams will revert back to 4 on 3 or 3 on 3, as appropriate.

Overtime – Operations for Semifinals or for the Bronze Medal Game

- If, at the end of the three (3) 20-minute periods of the semifinal games or the Bronze Medal Game, the two (2) playing teams are tied, the teams will then play a 'sudden death' overtime period of 10 minutes, with the team that scores first being declared the winner.
- The overtime period shall be played with each team at a numerical strength of three (3) skaters and one (1) goaltender.
- The overtime period will commence following a three (3)-minute intermission. Once the intermission has been completed, the clock will be reset to 10 minutes and the overtime period will begin immediately.
- Teams will not change ends. The players will remain on their respective benches during the three (3) minutes. Goaltenders must go to their respective benches during this rest period; however, penalized players must remain in the penalty box. Should a penalized player exit the penalty box, he/she shall be returned immediately by the game officials with no additional penalty being assessed, unless he/she commits an infraction of any other rule.
- Teams are not permitted to return to the dressing room during this time.

Penalties

- When regulation time ends, and the teams are 5 on 3, teams will start the overtime period 5 on 3. Once player strength reaches 5 on 4 or 5 on 5, at the next stoppage of play, player strength is adjusted to 4 on 3 or 4 on 4, as appropriate. When regulation time ends, and teams are 4 on 4, teams will start overtime 4 on 4.

- Once player strength reaches 5 on 4 or 5 on 5, at the next stoppage, player strength is adjusted to 4 on 3 or 4 on 4, as appropriate. If, at the end of regulation time, teams are 3 on 3, overtime starts 3 on 3. Once player strength reaches 4 on 4, 5 on 4 or 5 on 5, at the next stoppage of play, player strength is adjusted to 4 on 3 or 4 on 4, as appropriate. At no time will a team have less than three (3) players on the ice. If a team is penalized in overtime, teams play 4 on 3. If both teams are penalized with minor penalties at the same stoppage of play (with no other penalties in effect), teams will continue to play 4 on 4. In overtime, if a team is penalized such that a two (2)-man advantage is called for, then the offending team will remain at three (3) skaters while the non-offending team will be permitted five (5) skaters. At the first stoppage of play after the two (2)-man advantage is no longer in effect, the numerical strength of the teams will revert to 4 on 3 or 4 on 4, as appropriate.

Overtime – Operations for the Gold Medal Game

- If, at the end of the three (3) 20-minute periods in a Gold Medal Game the two (2) playing teams are tied, the teams will then play a 'sudden death' overtime period of 20 minutes with the team that scores first being declared the winner. The overtime period shall be played with each team at a numerical strength of three (3) skaters and one (1) goaltender.
- The overtime period will commence following an ice resurfacing during a 15-minute intermission where the teams will return to their dressing room before the start of the overtime period. Teams will not change ends.

5.5.7 PENALTY-SHOT SHOOTOUT PROCEDURE (IIHF SPORT REGULATIONS)

- If, following the completion of regulation time in any IIHF Championship game the score of the game is tied, the teams will then play an overtime period with a maximum duration and number of players as specified in the IIHF Sport Regulations with the team that scores first being declared the winner.
- If no goal is scored in the overtime period, then the IIHF Penalty-Shot Shootout Procedure will apply. The following procedure will be utilized:
 - Shots will be taken at both ends of the ice surface. The 14-meter-wide longitudinal center section of the rink, between the face-off dots in the neutral and end zones, will be dry scraped by the ice-resurfacing machine prior to the Penalty-Shot Shootout during the time required to organize the program accordingly.
 - The procedure will begin with five (5) different shooters from each team taking alternate shots. The players do not need to be named beforehand. Players eligible to participate in the Penalty-Shot Shootout will be the four (4) goalkeepers and all players from both teams listed on the official game sheet, except as specified in article 3 below.
 - Any player whose penalty had not been completed when the overtime period ended is not eligible to be one of the players selected to take the penalty shots

and must remain in the penalty box or in the dressing room. Also, players serving penalties assessed during the Penalty Shot Shootout must remain in the penalty box or in the dressing room until the end of the procedure.

- The Referee will call the two (2) captains to the Referee Crease and flip a coin to determine which team takes the first shot. The winner of the coin toss will have the choice whether his/her team will shoot first (1st) or second (2nd).
- The goalkeepers shall defend the same goal as in the overtime period and may remain at their goal creases while the opposing team is taking a shot.
- The goalkeepers from each team may be changed after each shot.
- The shots will be taken in accordance with Rule 63 of the IIHF Official Rule Book.
- The players of both teams will take the shots alternately until a decisive goal is scored. The remaining shots will not be taken.
- If the score is still tied after all shots are taken by each team, the procedure shall continue with a tiebreak shoot-out, using the same, or new, players. The team that shot second (2nd) in the first five (5) penalty shots will start first in the tie-break shots. The game shall be finished as soon as a duel of two (2) players brings the decisive result. The same player can be used for each shot by a team in the tie-break shoot-out.
- The official scorekeeper will record all shots taken, indicating the players, goalkeepers and goals scored.
- Only the decisive goal will count toward the result of the game. It shall be credited to the team that scored the goal and charged against the team that was scored upon.
- If a team declines to participate in the Penalty-Shot Shootout, the game will be declared as a loss for that team and the other team will be awarded three (3) points for a win. If a player declines to take a shot it will be declared “no score” for his/her team.

5.6 Competition and Training Venue Information

5.6.1 GENERAL INFORMATION

Venue	Function	Manager	Distance from accommodation to venue
Cheel Arena (Men)	Training/ Competition	Logan Norris	1.5 miles (2.41 km)

Roos House (Men)	Training/ Competition	Patrick Harrington	13 miles (20.9 km)
Maxcy Hall (Women)	Training/ Competition	Patrick O'Brien	0.12 miles (0.2 km)
Olympic Center	Semifinals/Finals	Chadd Cassidy	0.19 miles (0.3 km)

5.6.2 VENUE LAYOUTS

See Appendix, Section 8.2.

5.7 Day by Day Schedule

"For all televised events, the competition session begins at the stated time, but the actual competition/play will begin five (5) minutes afterwards for broadcast purposes."

Key	
Training	Light Blue
Competition	Dark Blue
Reserve Days	White
Meeting Days/Additional Information	Yellow
Ceremonies/Social Events	Red

SPORT	DATE	DAY	START TIME	FINISH TIME	EVENT NAME	VENUE
Ice Hockey Men	7-Jan-23	SAT	8:00	9:00	Training - TBD - bookable - Maxcy team	CHA
Ice Hockey Men	7-Jan-23	SAT	9:15	10:15	Training - TBD - bookable - Cheel team	CHA
Ice Hockey Men	7-Jan-23	SAT	10:30	11:30	Training - TBD - bookable - Cheel team	CHA
Ice Hockey Men	7-Jan-23	SAT	11:45	12:45	Training - TBD - bookable - Maxcy team	CHA
Ice Hockey Men	7-Jan-23	SAT	18:00	19:00	Training - TBD - bookable - Maxcy team	CHA
Ice Hockey Men	7-Jan-23	SAT	19:15	20:15	Training - TBD - bookable - Cheel team	CHA
Ice Hockey Men	7-Jan-23	SAT	12:00	13:00	Training - TBD - bookable	ROH
Ice Hockey Men	7-Jan-23	SAT	13:15	14:15	Training - TBD - bookable	ROH

Ice Hockey Men	7-Jan-23	SAT	14:30	15:30	Training - TBD - bookable	ROH
Ice Hockey Men	7-Jan-23	SAT	15:45	16:45	Training - TBD - bookable	ROH
Ice Hockey Men	7-Jan-23	SAT	17:00	18:00	Training - TBD - bookable	ROH
Ice Hockey Men	7-Jan-23	SAT	18:15	19:15	Training - TBD - bookable	ROH
Ice Hockey Women	7-Jan-23	SAT	12:00	13:00	Training - TBD - bookable	MAH
Ice Hockey Women	7-Jan-23	SAT	13:15	14:15	Training - TBD - bookable	MAH
Ice Hockey Women	7-Jan-23	SAT	14:30	15:30	Training - TBD - bookable	MAH
Ice Hockey Women	7-Jan-23	SAT	15:45	16:45	Training - TBD - bookable	MAH
Ice Hockey Women	7-Jan-23	SAT	17:00	18:00	Training - TBD - bookable	MAH
Ice Hockey Women	7-Jan-23	SAT	18:15	19:15	Training - TBD - bookable	MAH
Ice Hockey Men	8-Jan-23	SUN	11:00	12:00	Training - TBD - bookable - Maxcy team	CHA
Ice Hockey Men	8-Jan-23	SUN	12:15	13:15	Training - TBD - bookable - Cheel team	CHA
Ice Hockey Men	8-Jan-23	SUN	13:15	13:45	Ice Maintenance	CHA
Ice Hockey Men	8-Jan-23	SUN	13:45	14:45	Training - TBD - bookable - Cheel team	CHA
Ice Hockey Men	8-Jan-23	SUN	15:00	16:00	Training - TBD - bookable - Maxcy team	CHA
Ice Hockey Men	8-Jan-23	SUN	16:00	16:45	Ice Maintenance	CHA
Ice Hockey Men	8-Jan-23	SUN	16:45	17:45	Training - TBD - bookable - Cheel team	CHA
Ice Hockey Men	8-Jan-23	SUN	18:00	19:00	Training - TBD - bookable - Maxcy team	CHA
Ice Hockey Men	8-Jan-23	SUN	12:00	13:00	Training - TBD - bookable	ROH
Ice Hockey Men	8-Jan-23	SUN	13:15	14:15	Training - TBD - bookable	ROH
Ice Hockey Men	8-Jan-23	SUN	14:30	15:30	Training - TBD - bookable	ROH
Ice Hockey Men	8-Jan-23	SUN	15:45	16:45	Training - TBD - bookable	ROH
Ice Hockey Men	8-Jan-23	SUN	17:00	18:00	Training - TBD - bookable	ROH
Ice Hockey Men	8-Jan-23	SUN	18:15	19:15	Training - TBD - bookable	ROH

Ice Hockey Women	8-Jan-23	SUN	12:00	13:00	Training - TBD - bookable	MAH
Ice Hockey Women	8-Jan-23	SUN	13:15	14:15	Training - TBD - bookable	MAH
Ice Hockey Women	8-Jan-23	SUN	14:30	15:30	Training - TBD - bookable	MAH
Ice Hockey Women	8-Jan-23	SUN	15:45	16:45	Training - TBD - bookable	MAH
Ice Hockey Women	8-Jan-23	SUN	17:00	18:00	Training - TBD - bookable	MAH
Ice Hockey Women	8-Jan-23	SUN	18:15	19:15	Training - TBD - bookable	MAH
Ice Hockey Men	9-Jan-23	MON	12:00	13:00	Training - TBD - bookable - Maxcy team	CHA
Ice Hockey Men	9-Jan-23	MON	13:15	14:15	Training - TBD - bookable - Cheel team	CHA
Ice Hockey Men	9-Jan-23	MON	14:15	14:45	Ice Maintenance	CHA
Ice Hockey Men	9-Jan-23	MON	14:45	15:45	Training - TBD - bookable - Cheel team	CHA
Ice Hockey Men	9-Jan-23	MON	16:00	17:00	Training - TBD - bookable - Maxcy team	CHA
Ice Hockey Men	9-Jan-23	MON	17:00	17:45	Ice Maintenance	CHA
Ice Hockey Men	9-Jan-23	MON	17:45	18:45	Training - TBD - bookable - Cheel team	CHA
Ice Hockey Men	9-Jan-23	MON	19:00	20:00	Training - TBD - bookable - Maxcy team	CHA
Ice Hockey Men	9-Jan-23	MON	8:15	9:15	Referees	ROH
Ice Hockey Men	9-Jan-23	MON	12:00	13:00	Training - TBD - bookable	ROH
Ice Hockey Men	9-Jan-23	MON	13:15	14:15	Training - TBD - bookable	ROH
Ice Hockey Men	9-Jan-23	MON	14:30	15:30	Training - TBD - bookable	ROH
Ice Hockey Men	9-Jan-23	MON	15:45	16:45	Training - TBD - bookable	ROH
Ice Hockey Men	9-Jan-23	MON	17:00	18:00	Training - TBD - bookable	ROH
Ice Hockey Men	9-Jan-23	MON	18:15	19:15	Training - TBD - bookable	ROH
Ice Hockey Women	9-Jan-23	MON	12:00	13:00	Training - TBD - bookable	MAH
Ice Hockey Women	9-Jan-23	MON	13:15	14:15	Training - TBD - bookable	MAH
Ice Hockey Women	9-Jan-23	MON	14:30	15:30	Training - TBD - bookable	MAH

Ice Hockey Women	9-Jan-23	MON	15:45	16:45	Training - TBD - bookable	MAH
Ice Hockey Women	9-Jan-23	MON	17:00	18:00	Training - TBD - bookable	MAH
Ice Hockey Women	9-Jan-23	MON	18:15	19:15	Training - TBD - bookable	MAH
Ice Hockey Women	9-Jan-23	MON	19:30	20:30	Referees	MAH
Ice Hockey Men	9-Jan-23	MON	17:00	19:00	FISU International Technical Committee Meeting	CHP
Ice Hockey Women	9-Jan-23	MON	17:00	19:00	FISU International Technical Committee Meeting	CHP
Ice Hockey Men	10-Jan-23	TUE	9:00	10:00	1st Technical Official's Meeting (ITO)	HAM
Ice Hockey Women	10-Jan-23	TUE	9:00	10:00	1st Technical Official's Meeting (ITO)	HAM
Ice Hockey Men	10-Jan-23	TUE	12:00	13:00	Training - TBD - bookable - Maxcy team	CHA
Ice Hockey Men	10-Jan-23	TUE	13:15	14:15	Test Game	CHA
Ice Hockey Men	10-Jan-23	TUE	14:30	15:30	Training - TBD - bookable - Cheel team	CHA
Ice Hockey Men	10-Jan-23	TUE	15:45	16:45	Training - TBD - bookable - Maxcy team	CHA
Ice Hockey Men	10-Jan-23	TUE	17:00	18:00	Training - TBD - bookable - Cheel team	CHA
Ice Hockey Men	10-Jan-23	TUE	18:15	19:15	Training - TBD - bookable - Cheel team	CHA
Ice Hockey Men	10-Jan-23	TUE	19:30	20:30	Training - TBD - bookable - Maxcy team	CHA
Ice Hockey Men	10-Jan-23	TUE	20:45	21:45	Referees	CHA
Ice Hockey Men	10-Jan-23	TUE	8:15	9:15	Test Game	ROH
Ice Hockey Men	10-Jan-23	TUE	12:00	13:00	Training - TBD - bookable	ROH
Ice Hockey Men	10-Jan-23	TUE	13:15	14:15	Training - TBD - bookable	ROH
Ice Hockey Men	10-Jan-23	TUE	14:30	15:30	Training - TBD - bookable	ROH
Ice Hockey Men	10-Jan-23	TUE	15:45	16:45	Training - TBD - bookable	ROH
Ice Hockey Men	10-Jan-23	TUE	17:00	18:00	Training - TBD - bookable	ROH
Ice Hockey Men	10-Jan-23	TUE	18:15	19:15	Training - TBD - bookable	ROH

Ice Hockey Men	10-Jan-23	TUE	20:45	21:45	Referees	ROH
Ice Hockey Women	10-Jan-23	TUE	10:45	11:45	Test Game	MAH
Ice Hockey Women	10-Jan-23	TUE	12:00	13:00	Training - TBD - bookable	MAH
Ice Hockey Women	10-Jan-23	TUE	13:15	14:15	Training - TBD - bookable	MAH
Ice Hockey Women	10-Jan-23	TUE	14:30	15:30	Training - TBD - bookable	MAH
Ice Hockey Women	10-Jan-23	TUE	15:45	16:45	Training - TBD - bookable	MAH
Ice Hockey Women	10-Jan-23	TUE	17:00	18:00	Training - TBD - bookable	MAH
Ice Hockey Women	10-Jan-23	TUE	18:15	19:15	Training - TBD - bookable	MAH
Ice Hockey Women	10-Jan-23	TUE	20:45	21:45	Referees	MAH
Ice Hockey Men	10-Jan-23	TUE	15:30	16:30	1st Technical Committee Meeting	CHA
Ice Hockey Women	10-Jan-23	TUE	15:30	16:30	1st Technical Committee Meeting	MAH
Ice Hockey Men	10-Jan-23	TUE	16:30	17:30	Head Coaches Rule Information Meeting (HCRIM)	CHA
Ice Hockey Women	10-Jan-23	TUE	16:30	17:30	Head Coaches Rule Information Meeting (HCRIM)	MAH
Ice Hockey Men	10-Jan-23	TUE	16:30	17:30	Medical Meeting	CHA
Ice Hockey Women	10-Jan-23	TUE	16:30	17:30	Medical Meeting	MAH
Ice Hockey Men	10-Jan-23	TUE	18:00	19:00	Directorate #1 (1st General Technical Meeting)	CHA
Ice Hockey Women	10-Jan-23	TUE	18:30	19:30	Directorate #1 (1st General Technical Meeting)	MAH
Ice Hockey Men	11-Jan-23	WED	7:00	7:45	Referees	CHA
Ice Hockey Men	11-Jan-23	WED	8:00	8:45	KAZ Training	CHA
Ice Hockey Men	11-Jan-23	WED	9:00	9:30	GBR Warm-up	CHA
Ice Hockey Men	11-Jan-23	WED	9:45	10:15	USA Warm-up	CHA
Ice Hockey Men	11-Jan-23	WED	13:00	15:15	HUN - SVK	CHA

Ice Hockey Men	11-Jan-23	WED	20:00	22:15	GBR - USA	CHA
Ice Hockey Men	11-Jan-23	WED	7:00	7:45	Referees	ROH
Ice Hockey Men	11-Jan-23	WED	8:00	8:30	JPN Warm-up	ROH
Ice Hockey Men	11-Jan-23	WED	8:45	9:15	LAT Warm-up	ROH
Ice Hockey Men	11-Jan-23	WED	9:30	10:15	SWE Training	ROH
Ice Hockey Men	11-Jan-23	WED	10:30	11:15	CZE Training	ROH
Ice Hockey Men	11-Jan-23	WED	11:30	12:15	UKR Training	ROH
Ice Hockey Men	11-Jan-23	WED	12:30	13:15	CAN Training	ROH
Ice Hockey Men	11-Jan-23	WED	16:30	18:45	JPN - LAT	ROH
Ice Hockey Women	11-Jan-23	WED	7:00	7:45	Referees	MAH
Ice Hockey Women	11-Jan-23	WED	8:00	8:30	GBR Warm-up	MAH
Ice Hockey Women	11-Jan-23	WED	8:45	9:15	CZE Warm-up	MAH
Ice Hockey Women	11-Jan-23	WED	9:30	10:00	SVK Warm-up	MAH
Ice Hockey Women	11-Jan-23	WED	10:15	10:45	CAN Warm-up	MAH
Ice Hockey Women	11-Jan-23	WED	12:00	12:45	USA Training	MAH
Ice Hockey Women	11-Jan-23	WED	13:00	13:45	JPN Training	MAH
Ice Hockey Men	11-Jan-23	WED	14:00	14:45	KOR Training	MAH
Ice Hockey Women	11-Jan-23	WED	16:30	18:45	GBR - CZE	MAH
Ice Hockey Women	11-Jan-23	WED	20:00	22:15	SVK - CAN	MAH
Ice Hockey Men	12-Jan-23	THU	8:00	8:45	GBR Training	CHA
Ice Hockey Men	12-Jan-23	THU	10:00	10:45	SVK Training	CHA
Ice Hockey Men	12-Jan-23	THU	11:00	11:45	USA Training	CHA
Ice Hockey Men	12-Jan-23	THU	13:00	15:15	KOR - KAZ	CHA
Ice Hockey Men	12-Jan-23	THU	9:30	11:45	SWE - CZE	ROH

Ice Hockey Men	12-Jan-23	THU	13:00	15:15	UKR - CAN	ROH
Ice Hockey Men	12-Jan-23	THU	7:00	7:45	HUN Training	MAH
Ice Hockey Women	12-Jan-23	THU	8:00	8:45	GBR Training	MAH
Ice Hockey Women	12-Jan-23	THU	9:00	9:45	CZE Training	MAH
Ice Hockey Women	12-Jan-23	THU	10:00	10:45	SVK Training	MAH
Ice Hockey Women	12-Jan-23	THU	11:00	11:45	CAN Training	MAH
Ice Hockey Women	12-Jan-23	THU	13:00	15:15	USA - JPN	MAH
Ice Hockey Men & Women	12-Jan-23	THU	19:00	20:30	Opening Ceremony	OCN
Ice Hockey Men	13-Jan-23	FRI	9:30	11:45	KAZ - HUN	CHA
Ice Hockey Men	13-Jan-23	FRI	13:00	13:30	SVK Warm-up	CHA
Ice Hockey Men	13-Jan-23	FRI	14:00	14:30	GBR Warm-up	CHA
Ice Hockey Men	13-Jan-23	FRI	15:00	15:45	USA Train	CHA
Ice Hockey Men	13-Jan-23	FRI	20:00	22:15	SVK - GBR	CHA
Ice Hockey Men	13-Jan-23	FRI	8:00	8:30	CZE Warm-up	ROH
Ice Hockey Men	13-Jan-23	FRI	8:45	9:15	JPN Warm-up	ROH
Ice Hockey Men	13-Jan-23	FRI	10:00	10:45	LAT Training	ROH
Ice Hockey Men	13-Jan-23	FRI	11:00	11:45	UKR Training	ROH
Ice Hockey Men	13-Jan-23	FRI	13:00	15:15	CAN - SWE	ROH
Ice Hockey Men	13-Jan-23	FRI	16:30	18:45	CZE - JPN	ROH
Ice Hockey Women	13-Jan-23	FRI	8:00	8:30	JPN Warm-up	MAH
Ice Hockey Women	13-Jan-23	FRI	8:45	9:15	SVK Warm-up	MAH
Ice Hockey Women	13-Jan-23	FRI	9:30	10:00	CZE Warm-up	MAH
Ice Hockey Women	13-Jan-23	FRI	10:15	10:45	USA Warm-up	MAH
Ice Hockey Women	13-Jan-23	FRI	12:00	12:45	CAN Training	MAH

Ice Hockey Women	13-Jan-23	FRI	13:00	13:45	GBR Training	MAH
Ice Hockey Men	13-Jan-23	FRI	14:00	14:45	KOR Training	MAH
Ice Hockey Women	13-Jan-23	FRI	16:30	18:45	JPN - SVK	MAH
Ice Hockey Women	13-Jan-23	FRI	20:00	22:15	CZE - USA	MAH
Ice Hockey Men	13-Jan-23	FRI	23:00	0:00	Directorate #2	CHA
Ice Hockey Women	13-Jan-23	FRI	23:00	0:00	Directorate #2	MAH
Ice Hockey Men	14-Jan-23	SAT	9:30	10:00	USA Warm-up	CHA
Ice Hockey Men	14-Jan-23	SAT	10:15	10:45	KOR Warm-up	CHA
Ice Hockey Men	14-Jan-23	SAT	12:00	12:45	KAZ Training	CHA
Ice Hockey Men	14-Jan-23	SAT	13:00	13:45	SVK Training	CHA
Ice Hockey Men	14-Jan-23	SAT	20:00	22:15	USA - KOR	CHA
Ice Hockey Men	14-Jan-23	SAT	8:00	8:30	LAT Warm-up	ROH
Ice Hockey Men	14-Jan-23	SAT	8:45	9:15	UKR Warm-up	ROH
Ice Hockey Men	14-Jan-23	SAT	11:00	11:45	CAN Training	ROH
Ice Hockey Men	14-Jan-23	SAT	12:00	12:45	SWE Training	ROH
Ice Hockey Men	14-Jan-23	SAT	13:00	13:45	CZE Training	ROH
Ice Hockey Men	14-Jan-23	SAT	14:00	14:45	JPN Training	ROH
Ice Hockey Men	14-Jan-23	SAT	16:30	18:45	LAT - UKR	ROH
Ice Hockey Women	14-Jan-23	SAT	8:00	8:30	CZE Warm-up	MAH
Ice Hockey Women	14-Jan-23	SAT	8:45	9:15	CAN Warm-up	MAH
Ice Hockey Women	14-Jan-23	SAT	9:30	10:00	GBR Warm-up	MAH
Ice Hockey Women	14-Jan-23	SAT	10:15	10:45	SVK Warm-up	MAH
Ice Hockey Women	14-Jan-23	SAT	11:00	11:45	USA Training	MAH
Ice Hockey Women	14-Jan-23	SAT	12:00	12:45	JPN Training	MAH

Ice Hockey Men	14-Jan-23	SAT	13:00	13:45	GBR Training	MAH
Ice Hockey Men	14-Jan-23	SAT	14:00	14:45	HUN Training	MAH
Ice Hockey Women	14-Jan-23	SAT	16:30	18:45	CZE - CAN	MAH
Ice Hockey Women	14-Jan-23	SAT	20:00	22:15	GBR - SVK	MAH
Ice Hockey Men	15-Jan-23	SUN	8:00	8:30	SVK Warm-up	CHA
Ice Hockey Men	15-Jan-23	SUN	8:45	9:15	USA Warm-up	CHA
Ice Hockey Men	15-Jan-23	SUN	10:15	10:45	GBR Warm-up	CHA
Ice Hockey Men	15-Jan-23	SUN	11:00	11:30	KAZ Warm-up	CHA
Ice Hockey Men	15-Jan-23	SUN	16:30	18:45	SVK - USA	CHA
Ice Hockey Men	15-Jan-23	SUN	20:00	22:15	KAZ - GBR	CHA
Ice Hockey Men	15-Jan-23	SUN	9:30	11:45	CAN - JAP	ROH
Ice Hockey Men	15-Jan-23	SUN	13:00	15:15	CZE - LAT	ROH
Ice Hockey Men	15-Jan-23	SUN	16:00	16:45	UKR Training	ROH
Ice Hockey Men	15-Jan-23	SUN	17:00	17:45	SWE Training	ROH
Ice Hockey Women	15-Jan-23	SUN	8:00	8:30	CAN Warm-up	MAH
Ice Hockey Women	15-Jan-23	SUN	8:45	9:15	JPN Warm-up	MAH
Ice Hockey Women	15-Jan-23	SUN	9:30	10:00	USA Warm-up	MAH
Ice Hockey Women	15-Jan-23	SUN	10:15	10:45	GBR Warm-up	MAH
Ice Hockey Women	15-Jan-23	SUN	11:00	11:45	CZE Training	MAH
Ice Hockey Women	15-Jan-23	SUN	12:00	12:45	SVK Training	MAH
Ice Hockey Men	15-Jan-23	SUN	13:00	13:45	KOR Training	MAH
Ice Hockey Men	15-Jan-23	SUN	14:00	14:45	HUN Training	MAH
Ice Hockey Women	15-Jan-23	SUN	16:30	18:45	CAN - JPN	MAH
Ice Hockey Women	15-Jan-23	SUN	20:00	22:15	USA - GBR	MAH

Ice Hockey Women	15-Jan-23	SUN	23:00	0:00	Directorate #3	MAH
Ice Hockey Men	16-Jan-23	MON	8:00	8:30	KAZ Warm-up	CHA
Ice Hockey Men	16-Jan-23	MON	8:45	9:15	SVK Warm-up	CHA
Ice Hockey Men	16-Jan-23	MON	9:30	10:15	USA Training	CHA
Ice Hockey Men	16-Jan-23	MON	10:30	11:15	GBR Training	CHA
Ice Hockey Men	16-Jan-23	MON	16:30	18:45	KAZ - SVK	CHA
Ice Hockey Men	16-Jan-23	MON	10:15	10:45	UKR Warm-up	ROH
Ice Hockey Men	16-Jan-23	MON	11:00	11:30	SWE Warm-up	ROH
Ice Hockey Men	16-Jan-23	MON	12:00	12:45	JPN Training	ROH
Ice Hockey Men	16-Jan-23	MON	13:00	13:45	CAN Training	ROH
Ice Hockey Men	16-Jan-23	MON	14:00	14:45	LAT Training	ROH
Ice Hockey Men	16-Jan-23	MON	15:00	15:45	CZE Training	ROH
Ice Hockey Men	16-Jan-23	MON	20:00	22:15	UKR - SWE	ROH
Ice Hockey Women	16-Jan-23	MON	7:00	7:30	USA Warm-up	MAH
Ice Hockey Women	16-Jan-23	MON	7:45	8:15	SVK Warm-up	MAH
Ice Hockey Women	16-Jan-23	MON	8:30	9:00	JPN Warm-up	MAH
Ice Hockey Women	16-Jan-23	MON	9:15	9:45	CZE Warm-up	MAH
Ice Hockey Women	16-Jan-23	MON	10:00	10:45	CAN Training	MAH
Ice Hockey Women	16-Jan-23	MON	11:00	11:45	GBR Training	MAH
Ice Hockey Men	16-Jan-23	MON	13:00	15:15	KOR - HUN	MAH
Ice Hockey Women	16-Jan-23	MON	16:30	18:45	USA - SVK	MAH
Ice Hockey Women	16-Jan-23	MON	20:00	22:15	JPN - CZE	MAH
Ice Hockey Men	16-Jan-23	MON	19:30	20:30	Directorate #3	CHA
Ice Hockey Men	17-Jan-23	TUE	10:00	10:45	KOR Training	CHA

Ice Hockey Men	17-Jan-23	TUE	11:00	11:45	USA Training	CHA
Ice Hockey Men	17-Jan-23	TUE	12:00	12:45	KAZ Training	CHA
Ice Hockey Men	17-Jan-23	TUE	13:00	13:45	SVK Training	CHA
Ice Hockey Men	17-Jan-23	TUE	8:00	8:30	SWE Warm-up	ROH
Ice Hockey Men	17-Jan-23	TUE	8:45	9:15	JPN Warm-up	ROH
Ice Hockey Men	17-Jan-23	TUE	9:30	10:15	UKR Training	ROH
Ice Hockey Men	17-Jan-23	TUE	10:30	11:15	CZE Training	ROH
Ice Hockey Men	17-Jan-23	TUE	13:00	15:15	LAT - CAN	ROH
Ice Hockey Men	17-Jan-23	TUE	16:30	18:45	SWE - JPN	ROH
Ice Hockey Women	17-Jan-23	TUE	7:00	7:30	CAN Warm-up	MAH
Ice Hockey Women	17-Jan-23	TUE	7:45	8:15	GBR Warm-up	MAH
Ice Hockey Men	17-Jan-23	TUE	9:30	11:45	HUN - GBR	MAH
Ice Hockey Women	17-Jan-23	TUE	12:00	12:30	SVK Warm-up	MAH
Ice Hockey Women	17-Jan-23	TUE	12:45	1:15	CZE Warm-up	MAH
Ice Hockey Women	17-Jan-23	TUE	13:30	14:15	USA Training	MAH
Ice Hockey Women	17-Jan-23	TUE	14:30	15:15	JPN Training	MAH
Ice Hockey Women	17-Jan-23	TUE	16:30	18:45	CAN - GBR	MAH
Ice Hockey Women	17-Jan-23	TUE	20:00	22:15	SVK - CZE	MAH
Ice Hockey Men	18-Jan-23	WED	9:30	11:45	USA - KAZ	CHA
Ice Hockey Men	18-Jan-23	WED	13:00	15:15	SVK - KOR	CHA
Ice Hockey Men	18-Jan-23	WED	8:00	8:30	CAN Warm-up	ROH
Ice Hockey Men	18-Jan-23	WED	8:45	9:15	CZE Warm-up	ROH
Ice Hockey Men	18-Jan-23	WED	9:30	10:00	JPN Warm-up	ROH
Ice Hockey Men	18-Jan-23	WED	10:15	10:45	UKR Warm-up	ROH

Ice Hockey Men	18-Jan-23	WED	11:00	11:45	SVK Training	ROH
Ice Hockey Men	18-Jan-23	WED	12:00	12:45	SWE Training	ROH
Ice Hockey Men	18-Jan-23	WED	16:30	18:45	CAN - CZE	ROH
Ice Hockey Men	18-Jan-23	WED	20:00	22:15	JPN - UKR	ROH
Ice Hockey Women	18-Jan-23	WED	8:00	8:30	JPN Warm-up	MAH
Ice Hockey Women	18-Jan-23	WED	8:45	9:15	GBR Warm-up	MAH
Ice Hockey Women	18-Jan-23	WED	9:30	10:00	CAN Warm-up	MAH
Ice Hockey Women	18-Jan-23	WED	10:15	10:45	USA Warm-up	MAH
Ice Hockey Women	18-Jan-23	WED	11:00	11:45	SVK Training	MAH
Ice Hockey Women	18-Jan-23	WED	12:00	12:45	CZE Training	MAH
Ice Hockey Men	18-Jan-23	WED	13:00	13:45	HUN Training	MAH
Ice Hockey Men	18-Jan-23	WED	14:00	14:45	GBR Training	MAH
Ice Hockey Women	18-Jan-23	WED	16:30	18:45	JPN - GBR	MAH
Ice Hockey Women	18-Jan-23	WED	20:00	22:15	CAN - USA	MAH
Ice Hockey Women	18-Jan-23	WED	23:00	0:00	Directorate #4	MAH
Ice Hockey Men	19-Jan-23	THU	9:30	11:45	USA - HUN	CHA
Ice Hockey Men	19-Jan-23	THU	14:00	14:45	KAZ Training	CHA
Ice Hockey Men	19-Jan-23	THU	15:00	15:45	SVK Training	CHA
Ice Hockey Men	19-Jan-23	THU	8:00	8:30	LAT Warm-up	ROH
Ice Hockey Men	19-Jan-23	THU	8:45	9:15	SWE Warm-up	ROH
Ice Hockey Men	19-Jan-23	THU	9:30	10:00	CZE Warm-up	ROH
Ice Hockey Men	19-Jan-23	THU	10:15	10:45	UKR Warm-up	ROH
Ice Hockey Men	19-Jan-23	THU	11:00	11:45	JPN Training	ROH
Ice Hockey Men	19-Jan-23	THU	12:00	12:45	CAN Training	ROH

Ice Hockey Men	19-Jan-23	THU	16:30	18:45	LAT - SWE	ROH
Ice Hockey Men	19-Jan-23	THU	20:00	22:15	CZE - UKR	ROH
Ice Hockey Men	19-Jan-23	THU	13:00	15:15	GBR - KOR	MAH
Ice Hockey Women	19-Jan-23	THU	13:00	13:45	Women's Seed # 4 Training	OCN
Ice Hockey Women	19-Jan-23	THU	14:00	14:45	Women's Seed # 1 Training	OCN
Ice Hockey Women	19-Jan-23	THU	15:00	15:45	Women's Seed # 3 Training	OCN
Ice Hockey Women	19-Jan-23	THU	16:00	16:45	Women's Seed # 2 Training	OCN
Ice Hockey Women	19-Jan-23	THU	17:00	17:45	Women's referees	OCN
Ice Hockey Men	19-Jan-23	THU	23:00	0:00	Directorate #4	CHA
Ice Hockey Women	20-Jan-23	FRI	7:30	8:00	Women's Seed # 4 Warm-up	OCN
Ice Hockey Women	20-Jan-23	FRI	8:15	8:45	Women's Seed # 1 Warm-up	OCN
Ice Hockey Women	20-Jan-23	FRI	9:00	9:30	Women's Seed # 3 Warm-up	OCN
Ice Hockey Women	20-Jan-23	FRI	9:45	10:15	Women's Seed # 2 Warm-up	OCN
Ice Hockey Men	20-Jan-23	FRI	10:30	11:15	Men's 2nd Place Pool B Training	OCN
Ice Hockey Women	20-Jan-23	FRI	14:35	17:00	Women's Semi-Final # 1	OCN
Ice Hockey Men	20-Jan-23	FRI	17:30	18:15	Men's 1st Place Pool A Training	OCN
Ice Hockey Women	20-Jan-23	FRI	20:05	22:30	Women's Semi-Final # 2	OCN
Ice Hockey Women	20-Jan-23	FRI	23:00	0:00	Directorate #5	OCN
Ice Hockey Men	21-Jan-23	SAT	7:00	7:30	Men's referees	OCN
Ice Hockey Men	21-Jan-23	SAT	9:35	12:00	Men's Semi-Final # 1	OCN
Ice Hockey Men	21-Jan-23	SAT	13:05	15:30	Men's Semi-Final # 2	OCN
Ice Hockey Men	21-Jan-23	SAT	16:00	17:00	Directorate #5	OCN
Ice Hockey Women	21-Jan-23	SAT	17:05	19:30	Women's Bronze	OCN

Ice Hockey Women	21-Jan-23	SAT	20:35	23:00	Women's Gold	OCN
Ice Hockey Women	21-Jan-23	SAT	after gold medal game		Medal Ceremony	OCN
Ice Hockey Men	22-Jan-23	SUN	11:05	13:30	Men's Bronze	OCN
Ice Hockey Men	22-Jan-23	SUN	17:10	19:30	Men's Gold	OCN
Ice Hockey Men	22-Jan-23	SUN	after gold medal game		Medal Ceremony	OCN
Ice Hockey Men & Women	22-Jan-23	SUN	17:10		Closing Ceremony	OCN

5.7.1 TRAINING

Training Times can be booked on Calendly ahead of time. More information, including links customized to each team to book times, were sent to all Delegations in November 2022.

5.7.2 GENERAL TECHNICAL MEETINGS

The 1st General Technical Meeting (Directorate #1) for Men will be held at 18:00, 10 January 2023, at Cheel Arena.

The 1st General Technical Meeting (Directorate #1) for Women will be held at 18:30, 10 January 2023, at Maxcy Hall.

All team managers must attend this meeting. At the 1st General Technical Meeting, the Head of Delegation or his/her representative shall confirm and sign the official list of players.

Any further details and clarifications which are not yet described in the Technical Handbook will be communicated at the respective Directorates' Meetings (see schedule in the table above).

5.8 Equipment

Ice Hockey Uniforms

- Each team must have at least two (2) full sets of jerseys and socks (one (1) set in light colors and one (1) set in dark colors), including two (2) extra jerseys for both sets. The basic color must cover, at least, approximately 80% of each item (excluding the player's name and number).

- Each team's players must be dressed uniformly in helmets, jerseys, pants and socks, with the jerseys and socks matching in color; except for the goaltender who may wear a helmet of different design and color to the rest of the team.
- Each player must have his/her surname on the back of the upper part of the jersey in block Latin letters, 10 cm high.
- Each player must have his/her number on the back of his/her jersey, between 25 and 30 cm high, and on the upper part of each sleeve, 10 cm high. Numbers are restricted to 1-99. Players must play with the same number throughout the competition.

Advertising on the uniforms shall follow FISU Ice Hockey Uniform guidelines. Any logo or advertising not following these rules and guidelines must be removed/hidden from the uniforms. The uniform must be controlled by the FISU Winter Games Department and the FISU Marketing Department. Two (2) weeks prior to production – at the latest three (3) months before the event, photos of the front, back and each side (sleeves) of each uniform must be sent to the FISU Winter Games Department (wintergames@fisunet) and the FISU Marketing Department (marketing@fisunet). The photo format needs to be as follows: JPEG file, maximum resolution and size 300dpi/500 KB. During the 1st General Technical Meeting (GTM), the Organizing Committee and FISU TCC, in coordination with FISU Marketing Department, will conduct a second (2nd) control on site.

5.9 Doping Control

Doping Control will be carried out in accordance with the WADA World Anti-Doping Code and FISU regulations. Conditions for doping control procedures will be provided during the competitions at all sports venues.

5.9.1 LIST OF PROHIBITED SUBSTANCES

The actual list of prohibited substances and methods is defined in accordance with WADA international standards. National University Sports Federations will be responsible for ensuring that their delegations, namely athletes, are made aware of the actual copy of the prohibited list. Ignorance of the prohibited list contents will in no way constitute a valid excuse for any participant of the Lake Placid 2023 FISU World University Games violating valid FISU Anti-Doping Rules. For the WADA list of prohibited substances and methods please refer to the following website: www.wada-ama.org.

5.9.2 TESTING

The required number of samples will be selected during the “in-competition” and “out-of-competition” periods in accordance with the Test Distribution Plan. “In-competition” is defined as the period commencing 12 hours before a competition in which the athlete is scheduled to participate through to the end of such competition, and the sample collection process related to

such competition. “Out-of-competition” is defined as any doping control which is not “in-competition.” During the Lake Placid 2023 FISU Games, athletes can be tested at any time without prior notice. Urine and/or blood samples will be collected in compliance with the WADA International Standard for Testing and Investigations (ISTI). A paperless system will be used for the sample collection. The testing will be conducted by Doping Control Officers (DCO) from the U.S. Anti-Doping Agency (USADA), an anti-doping organization accredited by WADA. Testing will be conducted under the supervision of the FISU International Medical Committee. Doping samples will be sent to the WADA-accredited anti-doping laboratory (LAD) in Montreal, Canada. All results will be sent to the Chairman of the FISU International Medical Committee and entered into the ADAMS system. In the event of a violation of FISU Anti-Doping rules, the responsibility of processing the results lies with the FISU International Medical Committee.

In the event of setting a national record, doping testing of the athlete is carried out at the expense of his/her National University Sports Federation.

5.9.3 DOPING CONTROL STATIONS

Doping control stations are located at each sports venue or in close proximity. The main doping control station is located in the Host City of Lake Placid. All doping control stations will be marked with signs, including signage directing athletes to the stations. After the completion of the doping control procedure, all samples collected at each doping control station will be delivered to the central doping control station together with the necessary support documentation (doping control protocols) for further registration in the ADAMS system. All samples will be packaged and sent to the WADA accredited anti-doping laboratory in accordance with international standards. All the information concerning the doping control program during the Lake Placid 2023 FISU World University Games is confidential according to WADA and FISU requirements. When visiting a doping control station, athletes are required to have accreditation cards.

Doping control stations for Ice Hockey athletes competing in finals will be located in the Olympic Center- one (1) level below the arena. There will be a locker room for the processing station, and then a second for the waiting area right across the hall. Doping Control stations will also be at Maxcy Hall, Cheel Arena and Roos House.

Doping control stations for out of competition controls and outside venue operating hours will be located at medical stations in various locations, being Knowles Hall, Great Escape, Paul Smith’s College (the Health Center) and Lake Placid Sports Medicine. If testing outside of competition, athletes may be required to test at the medical station nearest them.

5.9.4 THERAPEUTIC USE EXEMPTIONS (TUE)

Lake Placid 2023 FISU World University Games participants who require Therapeutic Use Exemption (TUE) must make an appropriate request to the National Anti-Doping Organization or International Federation before participation in the Lake Placid 2023 FISU Games. The World Anti-Doping Agency International Standard for TUE will be applied in this case. Every athlete who uses a substance or a method included in the list of prohibited substances is obliged to be in

possession of a completed TUE form of the established standard from the moment of arrival until the departure from the Village after the Closing Ceremony of the Lake Placid 2023 FISU World University Games.

If there is a need for the use of a prohibited substance or a prohibited method for medical reasons after the Opening Ceremony of the Lake Placid 2023 FISU World University Games, an athlete must submit a request for TUE to the FISU International Medical Committee as a matter of urgency. The responsibility for completing the TUE form and submitting an application to the FISU International Medical Committee lies with the delegation physician.

If the delegation does not have its own physician, the athlete shall submit a request for TUE with the attachment of medical documentation confirming the fact of providing him/her with emergency medical treatment to the FISU International Medical Committee.

5.9.5 STRUCTURE

Chair of FISU International Medical Committee	Dr. Dusan Hamar
OC Head of Medical Services & Doping Control	Dr. Tracey Viola

5.10 Mascots and Medals

5.10.1 MASCOT CEREMONY

Mascot Ceremonies will be combined with Medal Ceremonies for Ice Hockey.

5.10.2 MEDAL CEREMONY

- The Medal Ceremonies will be held at the Olympic Center's 1980 Herb Brooks Arena according to the detailed day-by-day schedule, as shown in Section 5.7.
- The official language for the Medal Ceremony will be English.
- The medalists of each event must attend the Medal Ceremony. In the event that a medalist is unable to attend, the medal will be delivered to an official of the relevant delegation. He/she must be dressed in the delegation's official outfit. He/she must not mount the podium but stand behind it. The awarders will hand the medal and mascot over the podium. During the FISU Anthem, the delegation official stands behind the podium.
- In the event that all medalists cannot be present, the Medal Ceremony will be postponed.

- If an athlete or team is disqualified, the medal(s) shall be returned to FISU.

During the Medal Ceremony:

- The athletes are not allowed to bring any national flag or any other national, cultural or religious symbol on the podium.
- The national flags of the first three (3) medalists will be raised and the only anthem played will be the FISU Anthem, the Gaudeamus Igitur.
- During the playing of the FISU Anthem and the raising of the flags, athletes shall face the flags and always conduct themselves in a dignified manner. No national anthem is played during the ceremony.
- Athletes are expected to take off their caps and sunglasses when receiving their medal and keep items in hand throughout the ceremony (i.e., playing of the FISU Anthem and raising of the flags).
- Athletes, authorities and accompanying persons are required to face the flags while they are being raised and the FISU Anthem is being played.
- The medalists are expected to attend the ceremony in the uniforms they wore at the Opening Ceremony but are also allowed to attend the official ceremony wearing sport uniforms when the ceremony takes place immediately following the competition.
- After the medals are awarded, athletes must remain in the awarding area for photos on the podium with medals.
- In order to get the best photos, athletes should follow the recommendations of photographers.

5.10.3 DIPLOMA OF HONOR

- The athletes ranked one (1) to eight (8) will receive a Diploma of Honor.
- For team events, each team member, from teams ranked one (1) to six (6), will receive a personal Diploma of Honor mentioning his/her name and the team ranking.
- Diplomas of Honor are not distributed at the Medal Ceremony. They are handed to the Head of Delegation or an appointed representative of each delegation prior to departure.
- If an athlete or team is disqualified, the diploma(s) shall be returned to FISU.

5.10.4 DIPLOMA OF MERIT

- For team sports, to the officials of medalist teams who are mentioned on the match sheet of their respective final game.

5.11 Media Interviews

- Venue Media Centers for media representatives are organized at all Lake Placid 2023 FISU World University Games competition sites.

- At the end of a competition, all athletes must leave the Field of Play through the mixed zone, where brief interviews will be held. Every athlete/coach should be ready to communicate with media representatives upon their request. Team representatives should be prepared to provide athletes with a warm jacket or a blanket prior to entering the mixed zone.
- A volunteer from the Venue Media Center will coordinate the exchanges between athletes/coaches and media.
- Support for translation in English will be provided during the mixed zone interviews. If an athlete/coach does not speak this language, they should invite their team interpreter to the mixed zone.
- Media conferences are held at the beginning and the end of the Lake Placid 2023 FISU World University Games.

5.12 Sport Information Services

5.12.1 ONLINE SPORT INFORMATION SERVICES

Online information will be available on the Lake Placid 2023 FISU World University Games' official website: <https://www.lakeplacid2023.com/>

In addition, more detailed information and publications for teams can be accessed under the following link: <https://www.lakeplacid2023.com/delegation-services/publications/>

5.12.2 SPORT INFORMATION CENTER (SIC)

The Sport Information Center will be located at Knowles Hall and provide the following information below.

The following services will be provided during the Lake Placid 2023 FISU World University Games:

- Competition schedule
- Training schedule
- Technical meeting information
- Distribution of daily sport results

The Sport Information Center will operate from 07:00-21:00, from 11-22 January 2023.

5.12.3 SPORT INFORMATION AT THE VENUE

A Sport Information Desk (SID) will be located at each venue, providing most recent information related to the competitions and receiving requests from the team representative(s). The Olympic Conference Center, for finals, and Cheel Arena, Maxcy Hall and Roos House will have desks open during training and competition.

- The Sport Information Desk will operate from 7 January 2023 until the final day of competition in accordance with the competitions and training schedules (one (1) hour before and after the events).

5.12.4 SPORT INFORMATION DISTRIBUTION

Information	Online	Venue	SIC	ITO Hotel
Competition Schedule	+	+	+	+
Start List/ Result List	+	+	+	+
Change to Schedule	+	+	+	+
Special Announcements	+	+	+	+
Weather Information	+	+	+	+
Medal Table	+			
Technical Handbook	+			
FISU Regulations	+			
Other Information		+	+	+
Answer to Team Questions		+	+	+

6. SERVICE INFORMATION

6.1 Team Services

6.1.1 TEAM SERVICE OFFICE

Team Service information can be retrieved from the Sport Information Desk at the venue or at the Service desk located at Knowles Hall.

6.1.2 TEAM SPORT ATTACHÉ

An additional attaché will be assigned to each Ice Hockey team for the entirety of their stay in Lake Placid. Team sport attachés will work on a flexible schedule, coordinated by the team leader/coach of the team.

Team sport attachés' responsibilities, generally, are as follows:

- Assistance during arrivals and departures of the delegations.
- Assistance with accreditation procedure, Village check-in and check-out procedures.

- Assistance with navigation in the Village and at the Lake Placid 2023 FISU World University Games venues, in the Village of Lake Placid.
- Assistance to the team at competition and training venues, UV, SIC and Sport Information Desks, the team's daily tasks management and solving any issues that may arise.
- Providing information regarding the competition and training schedule and any changes to the schedule.
- Assistance in ordering transportation for the team.
- Accompany the team to other Lake Placid 2023 FISU World University Games venues or the Village of Lake Placid, on request.
- Language support including unofficial consecutive interpreting.
- Information and communication support attachés are not obliged to follow the instructions of the team members not related to participation in the Lake Placid 2023 FISU Games. The transfer of documents, money and other valuables to attachés is not permitted.

6.1.3 DRESSING ROOMS

Each team will have a permanent dressing room during the tournament and extra coaches rooms. The storage area is located within the team area. Each team will receive lockers for storage reasons. Dressing rooms will be cleaned daily after each practice and game.

Each team (players and coaches) is asked to bring their own skate guards.

6.1.4 SKATE SHARPENING & EQUIPMENT REPAIR

A sharpening room is available for all teams. Each team is provided with a table for skate sharpening. Each team must bring its own skate sharpening machine, or, alternatively to share one made available at each venue.

In the event that external skate sharpening or equipment repair is required, please contact the Sport Information Desk and we will organize it for you. Skate sharpening is not allowed in front of the designated dressing room, only in the designated sharpening room.

6.1.5 LAUNDRY SERVICE

- Laundry service is provided by Team Services after each ice session.
- The laundry service only applies to sportswear (underwear, jerseys and socks). The sportswear must be delivered in a personal laundry bag. No laundry bags will be provided for the players, so each Delegation should bring its own.
- The laundry will be picked up by the LOC team service and delivered to and from your dressing room in a laundry trolley/roller container.
- The laundry bags must be brought by yourself and must be coded with the country name/color of the country. Please mark the name of the player on the label of the laundry loop with a waterproof marker. All garments, e.g., underwear, practice jerseys, socks, with

the exception of team jerseys, are washed in the laundry bags, which are not opened during the laundry process.

- Do not forget to close the loop carefully. Each team should leave their laundry bags in the same laundry trolley/roll container.

6.1.6 TOWELS

Each team is provided with 30 shower towels and 30 small towels each day.

6.1.7 PENALTY BOX

- Sealed water bottles, paper tissues and ice bags will be available in both penalty boxes during the game.
- Teams are allowed to bring their own drinks to the penalty box.

6.1.8 FITNESS ROOM AND BIKES

Bikes are available in designated warm-up areas.

Bikes are primarily reserved for the teams preparing for games. The bikes are split between the home and away teams. Teams are not allowed to move the bikes outside the fitness room.

All teams will also have access to fitness areas ((including gymnasiums, workout areas and a swimming pool) in Maxcy Hall throughout the Games. All teams will have access to shower areas in Maxcy Hall should they choose to make use of these fitness areas (and don't already have their own dedicated locker room in this venue).

6.1.9 OTHER ARENA SERVICES

- Water: Each team will be provided with enough water. Teams will bring their own drinking bottles to their respective benches. Drinks will be available in the team's dressing room.
- Fruits/Snacks will be available for both practices and games.
- Ice: Ice will be available both in the competition arenas as well as in the Village.

6.1.10 PUCKS

Practice pucks will be at the bench before practices. Teams are kindly advised to collect pucks from the ice after practice and return the pucks to the bench for the next team to practice. Only pucks provided from the OC are allowed to be used on ice.

Game warm-up pucks will be delivered to the team bench before the warm-up. OC staff will collect the pucks from the ice after the warm-up.

6.1.11 ICE PRACTICES - CANCELLATION

If a team is not using the scheduled ice slot for practice, the team attaché or team manager should inform the Sport Information Desk immediately, but no later than 12:00 noon the day before. Teams may also manage their practice schedules directly on the Calendly link provided to them.

6.1.12 OC CONTACT INFO

For any additional service at the arena, please contact the Sport Information Desk.

6.2 Accreditation

Accreditation can be obtained at the Welcome Center (Main Accreditation Center)

Location: Olympic Conference Center (third (3rd) floor)

2634 Main Street Lake Placid, NY 12946

Operating Dates: 7-23 January 2023

Operating Hours (subject to change):

- 7-14 January, 09:00 – 21:00
- 15-23 January, 09:00 – 15:00

IMPORTANT: A personalized accreditation card with a photo, name and function of the cardholder carries information about the access rights and privileges available to him/her. Upon arrival, the accreditation card, equipped with a QR-code, enables members of delegations a 24-hour temporary access to the Lake Placid 2023 FISU World University Games venues in accordance with the access rights on the accreditation card. The temporary access does not allow participation in the competition.

After the CIC approves the accreditation card, it will be fully activated.

6.3 Radio Frequency Control

At all Lake Placid 2023 FISU World University Games venues, any use of frequencies (e.g. on walkie-talkies, radio stations, wireless cameras, Wi-Fi access points, wireless microphones, FM-transmitters and any other wireless equipment), will require a temporary radio license from the Organizing Committee (OC). All Delegations have been contacted separately regarding radio frequency license requests. If anyone has not received or responded to this communication, please contact delegations@lakeplacid2023.com immediately.

Every wireless device must be registered by the frequency-organizer before it may be used.

- License-free*: wireless microphones and in-ear monitoring systems, frequency range: 470-694 MHz
- License obligation: walkie-talkies (two (2)-way radio) and telemetry.

* Only a limited number of shared frequencies are available. Registration is mandatory and such equipment will not have a dedicated channel.

6.4 Insurance and Responsibilities

Participating countries must adhere to the insurance requirements and conditions as stipulated in Section 5.6 of the FISU Winter Games General Regulations for the Lake Placid 2023 FISU World University Games.

6.5 Transportation

6.5.1 TRANSPORTATION SYSTEM FOR ATHLETES AND TEAM OFFICIALS (TA)

Ice Hockey (Men)

The transportation system for athletes and team officials will provide transport services from 7-22 January 2023. Routes in the transportation system for athletes and official delegation members are marked with the abbreviation “TA” (Transport Athletes). Vehicles are being equipped with placards indicating route number for the individual and team sports and spectating athletes.

Route Number	TA VW-CHA
Sport	Ice Hockey (Men)
Route	Knowles Hall to Cheel Arena
Distance to the Venue	2.3 miles (3.7 km)
Time	9 min

Route Number	TA VW-ROH
Sport	Ice Hockey (Men)
Route	Knowles Hall to Roos House
Distance to the Venue	13.7 miles (22 km)
Time	24 min

Ice Hockey (Men) teams advancing to the semifinals will be transported from Knowles Hall to Lake Placid, to the secondary housing location. The four men’s playoff teams will move to Lake Placid on 20 January. See Appendix 8.4 for more details. Once in Lake Placid, Ice Hockey (Men) teams will walk to training and competition.

Route Number	N/A (walking)
Sport	Ice Hockey (Men)
Route	Golden Arrow to Olympic Center
Distance to the Venue	0.19 miles (0.3 km)
Time	5 min

Ice Hockey (Women)

Due to the proximity of the venue from the accommodations, all Ice Hockey (Women) teams will walk to training and competition.

Route Number	N/A (walking)
Sport	Ice Hockey (Women)
Route	Knowles Hall to Maxcy Hall
Distance to the Venue	0.12 miles (0.2 km)
Time	3 min

Ice Hockey (Women) teams advancing to the semifinals will be transported from Knowles Hall to Lake Placid, to the secondary housing location. The four women's playoff teams will move to Lake Placid on 19 January. See Appendix 8.4 for more details. Once in Lake Placid, Ice Hockey (Women) teams will walk to training and competition.

Route Number	N/A (walking)
Sport	Ice Hockey (Women)
Route	Golden Arrow to Olympic Center
Distance to the Venue	0.19 miles (0.3 km)
Time	5 min

Transportation Service for Spectating Athletes and Officials

Scheduled buses are provided between Knowles Hall and the competition venues for spectating athletes from 10-22 January 2023. Buses will operate in accordance with the competition schedule. All athletes and officials, regardless of their delegation and sport, will have access to the bus transportation systems TS.

Detailed information will be available in the [Transportation Guide](#) for delegations.

6.6 Food and Beverages

Meals will be provided at Knowles Hall. Athlete dining will be on the second (2nd) floor of the Olympic Center from 7-24 January 2023 for teams competing in the semifinals and finals. The first meal will be provided on 7 January for lunch at 12:00. The last meal will be provided on 24 January until 10:30.

6.6.1 MEALTIMES

- Breakfast: 05:30 to 10:30
- Lunch: 11:00 to 16:00
- Dinner: 17:00 to 22:30*
- Snack: 22:30 to 00:00

OCN (FINALS)

- Breakfast: 06:30-10:30
- Lunch: 11:00-16:00
- Dinner: 17:00-22:30
- Late Snack: 22:30-00:00

*Dinner service will be available until midnight for those teams playing in late games.

6.6.2 FNB SERVICES AT THE COMPETITION VENUES

- Each team will be provided with drinks and snacks one (1) hour prior to the competition until one (1) hour following the competition, outside of their respective locker rooms. This service is provided from the start of the first official training.

6.7 Medical Services

6.7.1 CONDITIONS OF MEDICAL ASSISTANCE

- During the Lake Placid 2023 FISU World University Games, emergency medical assistance, in the event of life-threatening diseases and conditions or in any situation requiring urgent medical treatment, is provided to all client groups.
- Immediate (except for emergency) and planned medical care is provided based on:
 - an obligatory medical insurance agreement;
 - a paid medical service agreement;
 - a voluntary health insurance agreement.

6.7.2 MEDICAL SUPPORT STRUCTURE

- Medical stations for athletes and spectators at the competition venues.
- Mobile medical crews in the Field of Play of the competition venues.
- Ambulance crews at the competition venues.
- Dedicated hospitals and specialized medical facilities.

*Please refer to the [Medical Services Guide](#) for more details.

6.7.3 MEDICAL SUPPORT IN THE ACCOMMODATION SITES

Medical services will be offered on site at Knowles Hall. Details can be found in the Medical Services Guide.

6.7.4 DEDICATED HOSPITALS AND SPECIALIZED MEDICAL FACILITIES

- The Adirondack Medical Center is located at 203 Old Military Road, Lake Placid, NY 12946.
- Phone 518-523-3311
- Dedicated medical services will be provided onsite at Knowles Hall, 09:00 – 19:00 daily.
- The Canton-Potsdam Hospital is located at 50 Leroy St., Potsdam, NY, and the emergency room there is open 24 hours/day.

6.8 Weather and Climate

Lake Placid averages 102 inches (259 cm) of snow per year while the U.S. average is 28 inches (71.12 cm) of snow per year, with daily temperatures averaging 25°F to 1°F (-3°C to -17°C).

Weather information can be picked up at Sport Information Centers at each of the Villages as well as other locations, including on the Lake Placid 2023 FISU Games website.

7. OC Contacts

Title	Email
Accreditation	accreditation@lakeplacid2023.com
Sport Entries	sportentries@lakeplacid2023.com
Delegation Services	delegations@lakeplacid2023.com
ITO Service Desk	itoservices@lakeplacid2023.com

8. APPENDICES

8.1 Lake Placid 2023 FISU World University Games Competition Schedule

VERSION 6 NOV 2022 Subject to change All times are approximate		DAY 1 WED 11 January	DAY 2 THU 12 January	DAY 3 FRI 13 January	DAY 4 SAT 14 January	DAY 5 SUN 15 January	DAY 6 MON 16 January	DAY 7 TUE 17 January	DAY 8 WED 18 January	DAY 9 THU 19 January	DAY 10 FRI 20 January	DAY 11 SAT 21 January	DAY 12 SUN 22 January	MEDAL EVENTS	
SNOW SPORTS	CEREMONIES		Opening Ceremonies 19:00 - 20:30										Closing Ceremonies 19:30-20:00 Followed by Main Street Festivities		
	ALPINE SKIING Whitewater Mountain (WMT)		Official free skiing on Super-G course 10:00-12:00	Super-G W/M 10:00 - 11:30 W 13:00 - 15:00 M	Alpine Combined W 9:30 - 11:00 SG 13:00 - 14:00 SL	Alpine Combined M 9:30 - 11:00 SG 13:00 - 14:00 SL	Reserve Day	Giant Slalom W 9:30 - 11:00 1st run 12:30 - 14:00 2nd run	Giant Slalom M 9:30 - 11:30 1st run 13:00 - 15:00 2nd run	Mixed Team Parallel 11:00 - 13:00	Slalom W 9:30 - 11:00 1st run 12:30 - 14:00 2nd run	Slalom M 9:30 - 11:30 1st run 13:00 - 15:00 2nd run	Reserve Day	9	
	FREESTYLE & FREESKI Gore Mountain (GM)				Official Training 10:00-12:00 Ski Cross			SM Cross W/M 10:30-12:30 OT 13:00-14:00 Qualifications	Slopeside W/M 10:00-12:00 Qualifications	Big Air W/M 10:00-12:00 Qualifications	Big Air W/M 10:00-11:30 Finals	Reserve Day		6	
	SNOWBOARD Gore Mountain (GM)	Official Training 10:00-12:00 Snowboard Cross W/M	Snowboard Cross W/M 10:30-12:30 OT 13:00-14:00 Qualifications	Snowboard Cross W/M 10:30-13:00 Round Robin 13:30-14:00 Finals	Reserve Day	Official Training 13:00-15:00 Slopeside M/W	Official Training 13:00-15:00 Slopeside M/W	Slopeside W/M 13:00-15:00 Qualifications	Slopeside W/M 13:00-15:00 Qualifications	Big Air W/M 13:30 - 15:00 Qualifications	Big Air W/M 13:00 - 15:00 Finals	Parallel Slalom W/M 10:00 - 11:00 Qualifications 13:00 - 14:30 Finals	Parallel Slalom W/M 10:00 - 11:00 Qualifications 13:00 - 14:30 Finals	10	
	BIATHLON Mt. Van Hoevenberg (MVBH)	Open Training 11:00-13:00	Open Training 11:00-13:00	Official Training 12:15-14:00 M 14:15-16:00 W	Individual M/W 11:15-12:05 Zeroing W 12:15-13:00 15km M 13:45-14:35 Zeroing W 14:45-16:00 12.5km W	Official Training 12:45-14:30	Single Mixed Relay 13:15-13:45 Zeroing M/W 14:00-14:50 4km W+1.5km M	Official Training 13:00-14:30 W 15:00-16:30 W	Sprint M/W 12:00 - 12:50 Zeroing M 13:00 - 14:15 10km M 14:20 - 15:10 Zeroing W 15:20 - 16:05 7.5km W	Pursuit M/W 13:00 - 13:30 Zeroing M 14:00 - 14:25 12.5km M 15:20 - 16:05 10km W	Official Training 14:00 - 15:00 W 15:00 - 16:00 W	Mass Start M/W 13:00 - 13:30 Zeroing M 13:40 - 14:30 15km M 14:45 - 15:15 Zeroing W 15:25 - 16:10 12.5km W	Reserve Day	9	
	CROSS-COUNTRY SKIING Mt. Van Hoevenberg (MVBH)	Open Training 9:00-11:00	Official Training 9:00-11:00	Mixed Team Sprint [C] 8:00-8:55 Training W/M 9:00-10:00 Semifinals 10:00-10:30 Finals	Official Training 9:00-11:00	Sprint W/M [F] 8:00-8:55 Training W/M 9:00-9:55 Qualifications W/M 11:00-12:30 Finals W/M	Official Training 9:00-11:30	Individual W/M [C] 8:00-8:55 Training W 9:00-10:00 Sem W 10:00-10:25 Training M 10:30 - 12:00 10km M	Pursuit W/M [B] 8:00-8:55 Training W 9:00-9:30 Sem W 9:30-10:10 Training M 10:15-11:00 10km M	Official Training 9:00-11:00	Relay W/M 8:00-8:55 Training W 9:00-10:00 3x5km W [CFF] 10:05-10:55 Training M 11:00-12:45 4x7.5km M [CFF]	Official Training 9:00-12:00	Mass Start M/W 9:00-9:55 Training M 10:00-12:00 30km M [F] 12:00-12:55 Training W 13:00-14:00 15km W [F]		11
	NORDIC COMBINED Olympic Jumping Complex (OJC)	Official Training Ind. Gundersen W/M 13:00-15:30 S/P+2 18:00-19:30 CCS	Official Training Ind. Gundersen W/M 10:00-11:30 S/P+2 12:00-13:00 PCR 14:00-15:00 CCS	Individual Gundersen W/M 13:00-13:30 S/P Trial W/M 14:00-14:30 S/P+1 W/M 17:30-17:55 CCS OT M/W	Official Training 13:00-14:30 S/P+2 16:15-17:00 CCS	Mass Start W/M 15:00-15:30 CCS 30km W 16:00-16:40 CCS 10km W 19:00-19:30 S/P Trial W/M 20:00-20:30 S/P+1 W/M	Official Training 13:00-14:30 S/P+2 17:00-17:55 CCS	Official Training 14:00-15:30 S/P+1 W/M 18:00-18:30 CCS 2x (3x1.5km) W 19:00-19:45 2x (4x1.5km)	Mixed Team Nordic 12:00-12:45 S/P Trial 13:00-13:45 S/P+2 18:00 - 18:40 CCS 2x2.5km	Reserve Day	Team NH W/M 14:00-15:15 W Trial 17:30-18:20 W Trial 19:00-19:30 M Trial 20:00-21:30 M	Reserve Day	Mass Start M/W 14:00-14:15 Gold M 19:00-21:15 Gold W		7
	SKI JUMPING Olympic Jumping Complex (OJC)				Official Training 17:30-18:45 W (x3) 19:00-20:45 M (x3)	Official Training 11:00-12:15 W (x3) 12:30-14:15 M (x3)	Individual NH W/M 16:00-16:15 W Trial 17:00-18:00 W Trial 20:00-21:30 M (x2)	Official Training 17:00-20:00 (x3)	Mixed Team NH 17:00-17:30 Trial 18:00-19:30 Mixed Relay	Official Training 18:00-21:00 W/M (x3)	Team NH W/M 16:45-17:00 W Trial 17:30-18:20 W Trial 19:00-19:30 M Trial 20:00-21:30 M	Reserve Day		5	
	CURLING Sarcelle Lake Club Center (SLC)		Official Training 8:30-15:45		14:00-16:15 W1 19:00-21:15 M1	9:00-11:15 W2 14:00-16:15 M2 19:00-21:15 W3	9:00-11:15 M3 14:00-16:15 W4 19:00-21:15 M4	9:00-11:15 W5 14:00-16:15 M5 19:00-21:15 W6	9:00-11:15 M6 14:00-16:15 W7 19:00-21:15 M7	9:00-11:15 W8 14:00-16:15 M8 19:00-21:15 W9	9:00-11:15 M9 14:00-16:15 W9 19:00-21:15 SF W	14:00-16:15 Bronze W 19:00-21:15 Bronze M	14:00-16:15 Gold M 19:00-21:15 Gold W	2	
ICE SPORTS	FIGURE SKATING Olympic Center (OCN)	Official Training 8:00-16:40	Official Training 7:00-15:40	Ice Dance 13:00-15:10 Rhythm Dance Men 17:00-22:00 Short Dance Women 20:00-22:30 Free Dance Ice Dance 13:00-14:30 Free Skating Women 19:00-22:50 Free Skating Exhibition Gala 14:00-15:30	Women 13:00-18:30 Short Program Ice Dance 19:00-22:50 Free Skating	Men 13:00-16:30 Free Skating Women 19:00-22:50 Free Skating								8	
	ICE HOCKEY (MEN) Q: Cheong Eunsu (CHN) Q: Riha House (BHR) Q: Hockey Hall (MNH) SF & F: Olympic Center (OCN)	13:00-15:15 HUN-SVK (1) 16:30-18:45 JPN-LAT (2) 20:00-22:15 GBR-USA (3)	9:30-11:45 SWE-CZE (4) 13:00-15:15 CAN-SWE (5) 16:30-18:45 CZE-JPN (6) 20:00-22:15 SVK-GBR (7)	9:30-11:45 KAZ-HUN (7) 13:00-15:15 CAN-SWE (8) 16:30-18:45 CZE-JPN (9) 20:00-22:15 SVK-GBR (10)	13:00-15:15 LAT-UKR (11) 20:00-22:15 USA-KOR (12)	9:30-11:35 CAN-JPN (13) 13:00-15:15 CZE-LAT (14) 16:30-18:45 SVK-USA (15) 20:00-22:15 KAZ-GBR (16)	13:00-15:15 KOR-HUN (17) 16:30-18:45 KAZ-SVK (18) 20:00-22:15 UKR-SWE (19)	9:30-11:45 HUN-GBR (20) 13:00-15:15 SVK-KOR (21) 16:30-18:45 CAN-CZE (22) 20:00-22:15 JPN-UKR (23)	9:30-11:45 USA-KAZ (24) 13:00-15:15 SVK-KOR (25) 16:30-18:45 CAN-CZE (26) 20:00-22:15 JPN-UKR (27)			9:35-12:00 Semifinal 1 (21) 13:05-15:30 Semifinal 2 (32)	11:05-13:30 Bronze (33) 17:10-19:30 Gold (34)	1	
	ICE HOCKEY (WOMEN) Q: Hockey Hall (MNH) SF & F: Olympic Center (OCN)	16:30-18:45 GBR-CZE (1) 20:00-22:15 SVK-CAN (2)	13:00-15:15 USA-JPN (3)	16:30-18:45 JPN-SVK (4) 20:00-22:15 CZE-USA (5)	16:30-18:45 CZE-CAN (6) 20:00-22:15 GBR-SVK (7)	16:30-18:45 CAN-JPN (8) 20:00-22:15 USA-GBR (9)	16:30-18:45 SVK-SVK (10) 20:00-22:15 JPN-CZE (11)	16:30-18:45 CAN-GBR (12) 20:00-22:15 SVK-CZE (13)	16:30-18:45 JPN-GBR (14) 20:00-22:15 CAN-USA (15)		14:35-17:05 Semifinal 1 (14) 20:05-22:30 Semifinal 2 (15)	17:05-19:30 Bronze (18) 20:35-23:00 Gold (19)		1	
	SHORT TRACK SPEED SKATING Olympic Center (OCN)						Unofficial Training 9:00-17:00	Unofficial Training 9:00-17:00	Official Training 8:00-16:00	1500m W/M 16:00-18:30 2000m Mixed Team Relay 19:30-20:30 Q	500m W/M 16:00-18:30 3000m W/5000m M Relay 19:30-19:50 Q 2000m Mixed Team Relay 20:10-20:40 Final	1000m W/M 16:00-19:00 3000m W/5000m M Relay 19:30-20:30 Final		9	
	SPEED SKATING Olympic Center Oval (OCN)		Unofficial Training 10:30-16:30	Official Training 10:30-16:30	Official Training 10:30-16:30	5000m W/M 10:00-11:40	3000m W/5000m M 10:00-12:35	1500m W/M 10:00-11:30	Team Pursuit W/M 10:00-11:30	500m W/M Mixed Team Relay 10:00-12:30	Mass Start W/M 10:00-11:05	Reserve Day		13	
	MEDAL CEREMONIES														64

8.2 M and W Ice Hockey Detailed Schedule

3 VENUE M & W ICE HOCKEY SCHEDULE (training days)													
Start Time	End Time	Day -5 Sat			Day -4 Sun			Day -3 Mon			Day -2 Tue		
		07-Jan			08-Jan			09-Jan			10-Jan		
		CHEEL M Pool B	ROOS M Pool A	MAXCY W Pool	CHEEL M Pool B	ROOS M Pool A	MAXCY W Pool	CHEEL M Pool B	ROOS M Pool A	MAXCY W Pool	CHEEL M Pool B	ROOS M Pool A	MAXCY W Pool
08:15	09:15	8:00 practice TBD	Open	Open	Open	Open	Open	G Knights (w)	Referees	Bears	G Knights (M)	Test Game	Bears
09:30	10:30	9:15 practice TBD	Open	Open	Open	Open	Open	G Knights (M)	Roos	Bears	G Knights (w)	Roos	Bears
10:45	11:45	10:30 practice TBD	Open	Open	11:00 Maxcy team	Open	Open	G Knights (M)	Roos	Bears	G Knights (w)	Roos	Test Game
12:00	13:00	11:45 practice TBD	practice TBD	practice TBD	12:15 Cheel team	practice TBD	practice TBD	12:00 Maxcy team	practice TBD	practice TBD	Maxcy team	practice TBD	practice TBD
13:15	14:15	G Knights	practice TBD	practice TBD	13:15 - 13:45 Ice Maint.	practice TBD	practice TBD	13:15 Cheel team	practice TBD	practice TBD	Test Game	practice TBD	practice TBD
14:30	15:30	Women's Game	practice TBD	practice TBD	13:45 Cheel team	practice TBD	practice TBD	14:15 - 14:45 Ice Maint.	practice TBD	practice TBD	Cheel team	practice TBD	practice TBD
15:45	16:45	13:00 to 17:30	practice TBD	practice TBD	15:00 Maxcy team	practice TBD	practice TBD	14:45 Cheel team	practice TBD	practice TBD	Maxcy team	practice TBD	practice TBD
17:00	18:00	G Knights	practice TBD	practice TBD	16:00 - 16:45 Ice Maint.	practice TBD	practice TBD	16:00 Maxcy team & Ice Maint.	practice TBD	practice TBD	Cheel team	practice TBD	practice TBD
18:15	19:15	8:00 practice TBD	practice TBD	practice TBD	16:45 Cheel team	practice TBD	practice TBD	17:45 Cheel team	practice TBD	practice TBD	Cheel team	practice TBD	practice TBD
19:30	20:30	9:15 practice TBD	Open	Open	18:00 Maxcy team	Open	Open	19:00 Maxcy team	Roos	Referees	Maxcy team	Roos	Bears

3 VENUE M & W ICE HOCKEY SCHEDULE (competition and training days)																								
Start Time	End Time	Day -1 Wed			Start Time	End Time	Day 0 (Opening) Thu			Start Time	End Time	Day 1 Fri			Start Time	End Time	Day 2 Sat			Start Time	End Time	Day 3 Sun		
		CHEEL M Pool B	ROOS M Pool A	MAXCY W Pool	Time cells change		CHEEL M Pool B	ROOS M Pool A	MAXCY W Pool	Time cells change		CHEEL M Pool B	ROOS M Pool A	MAXCY W Pool	CHEEL M Pool B	ROOS M Pool A	MAXCY W Pool	CHEEL M Pool B	ROOS M Pool A	MAXCY W Pool	CHEEL M Pool B	ROOS M Pool A	MAXCY W Pool	
12-Jan																								
07:00		08:00	Referees	Referees	Referees	07:00	07:30	GKnights (M)		HUNM Train		07:00	08:00											
08:00		08:30	KAZ Train	JPN Warm	GBR Warm	07:00	08:00	7:00 to 8:45				08:00	08:30											
08:45		09:15		LAT Warm	CZE Warm	08:15	08:45					08:45	09:15	JPN Warm		SVK Warm	USA Warm	LAT Warm	CZE Warm	SVK Warm	USA Warm	JPN Warm	CAN Warm	
09:30		10:00	9:00 GBR Warm	SWE Train	SVK Warm	09:00	09:45	GBR Train		Spectator entry		09:30	10:00	CZE Warm		USA Warm	GBR Warm					Spectator entry		
09:30		11:45				09:30	11:45	SWE - CZE (4)		CZE Train		09:30	11:45	KAZ - HUN (7)								CAN - JPN (14)		
10:15		10:45	3:45 USA Warm	10:30 CZE Train	CAN Warm	10:00	10:45	USA Train		Spectator entry		10:15	10:45	10:00 LAT Train		UKR Train	KOR Warm	CAN Train	USA Train	GBR Warm	SVK Warm	CZE Warm	GBR Warm	
11:00		11:30				11:00	11:45	CAN Train		Spectator entry		11:00	11:45	UKR Train		CAN Train	KAZ Warm					Spectator entry		
12:00		12:30	HUNM Train			12:00	12:45	Spectator before		Spectator before		12:00	12:45									Spectator before		
12:00		12:30	Spectator entry			12:00	12:45	KOR - KAZ (5)		UKR - CAN (6)		USA - JPN (3)		Spectator entry		CAN Train		KAZ Train	SVK Train	CZE Train	GBR Train	Spectator before		
13:00		15:15	HUN - SVK (3)			13:00	15:15	KOR - KAZ (5)		UKR - CAN (6)		USA - JPN (3)		13:00		15:15	CAN - SWE (11)						CZE - LAT (15)	
13:00		13:45	Rooz (M)			13:00	13:45							13:00		13:45	SVK Warm		GBR Train		SVK Train	CZE Train	GBR Train	KORM Train
14:00		14:45	13:30 to 14:30			14:00	15:00	Transport to Opening Ceremony		A: GBR(U), CZE(U), USA(U), SVK(U), JPN(U), LAT(U) - 14:00 - 15:45		14:00		14:45	GBR Warm		KOR (M) Train	JPN Train	HUNM Train	CZE Train	GBR Train	SVK Train	UKR Train	
15:00		15:45	GKnights (W)			15:00	16:00	B: SVK(U), CAN(U), GER(U), USA(U), SWE(U), CZE(U) - 14:30 - 16:15		C: USA(U), JPN(U), KOR(U), KAZ(U), UKR(U), CAN(U) - 16:15 - 18:00		15:00		15:45	USA Train		Spectator entry						Spectator entry	
16:30		18:45	15:30 to 17:00			16:00	17:00	Opening Ceremony 19:00 - 20:30		Transport to Potsdam (Group A, B, C)		16:00		16:45			CZE - JPN (12)		JPN - SVK (4)		LAT - UKR (13)		CZE - CAN (6)	
17:00		18:00	GKnights (M)			17:00	18:00					16:00		16:45			Spectator entry						UKR Train	
18:00		19:00	17:15 to 18:45			18:00	19:00					16:00		19:00			Spectator entry						17:00 SWE Train	
19:00		20:00	Spectator entry			19:00	20:00					19:00		20:00			Spectator before						Spectator before	
20:00		22:15	GBR - USA (2)			19:00 to 21:00	20:00					20:00		22:15	SVK - GBR (8)		CZE - USA (5)		USA - KOR (10)		GBR - SVK (7)		KAZ - GBR (3)	
21:00		22:00	Rooz (W)			21:00 to 22:00	22:00					21:00		22:00										
22:00		23:00				22:00	23:00			Golden Knights, Roos, Bears ice time 15:00 - 18:00		22:00		23:00										

[illegible]

Key	
	Game/session time slot (except on Day 0 games combined into single session)
	Women's game/session
	Men's pool A game/session
	Men's pool B game/session
	Local team ice time

MAH
IHO-W
ROH
IHO-M

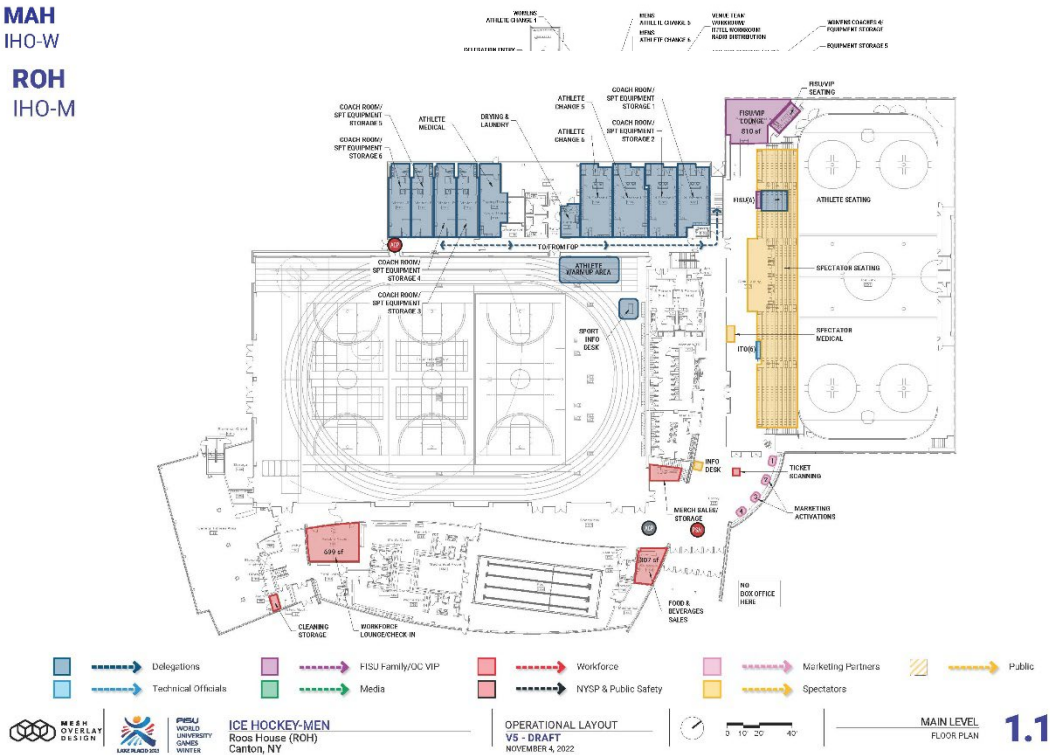

Women's & Men's

MAH
IHO-W
IHO-W/M

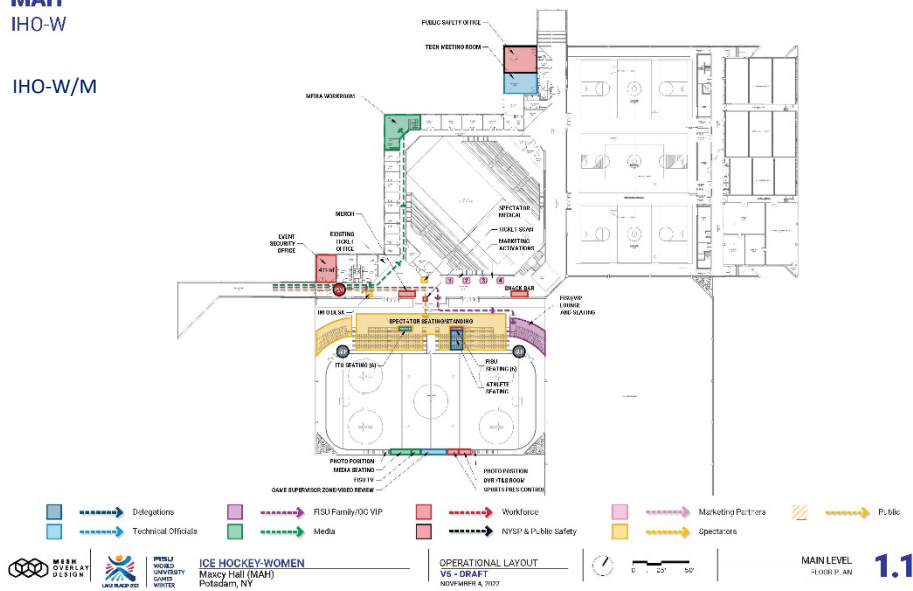

MAH IHO-W

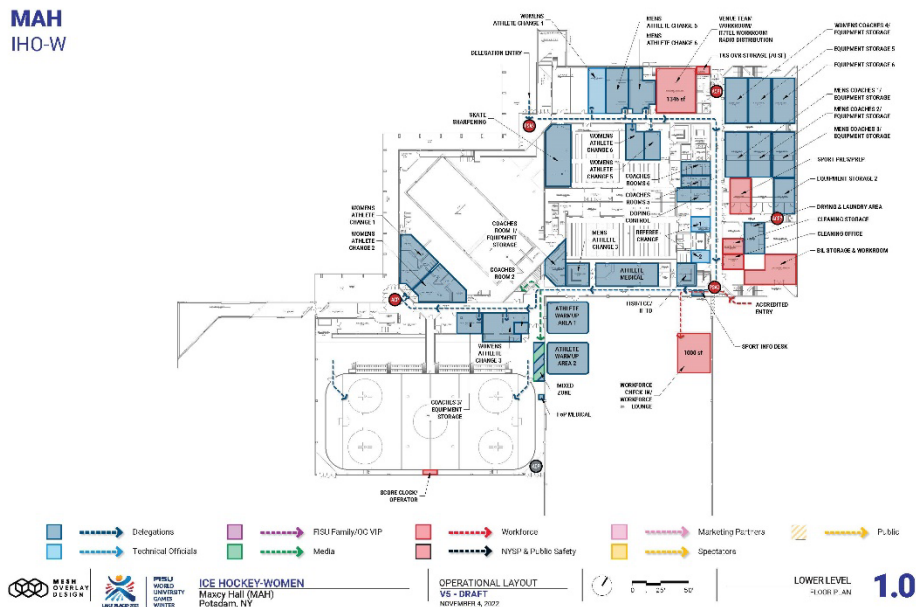

8.5 Geographical Overview Venues

OCN FSK IHO SSK STK

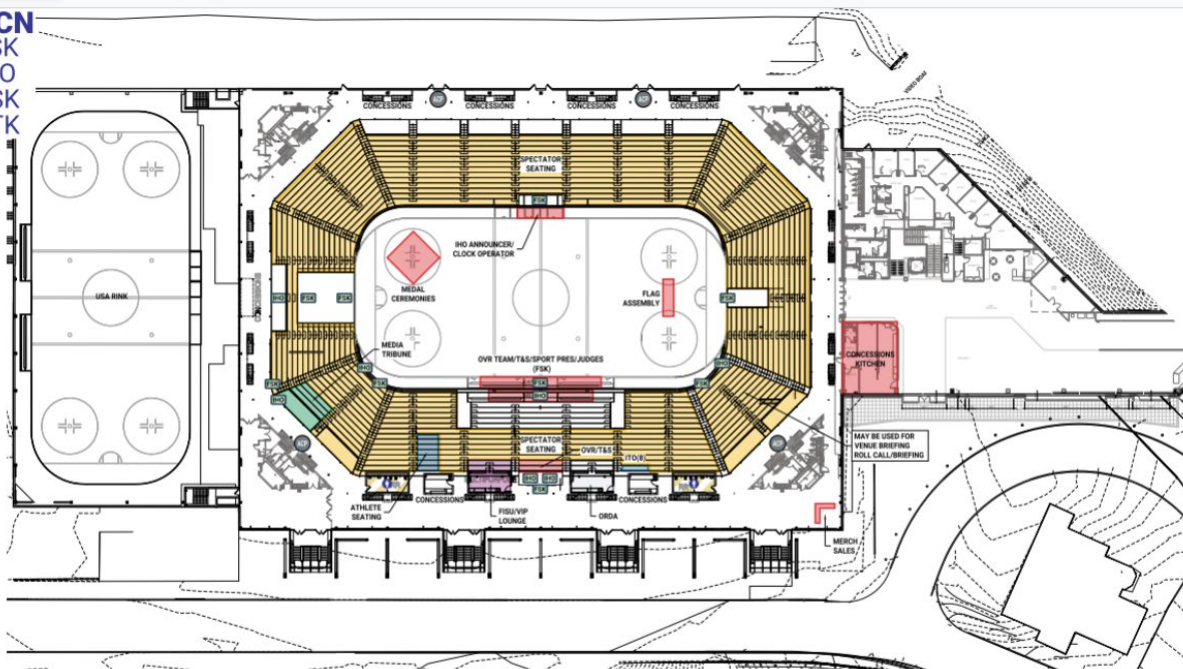

CHA
IHO-M

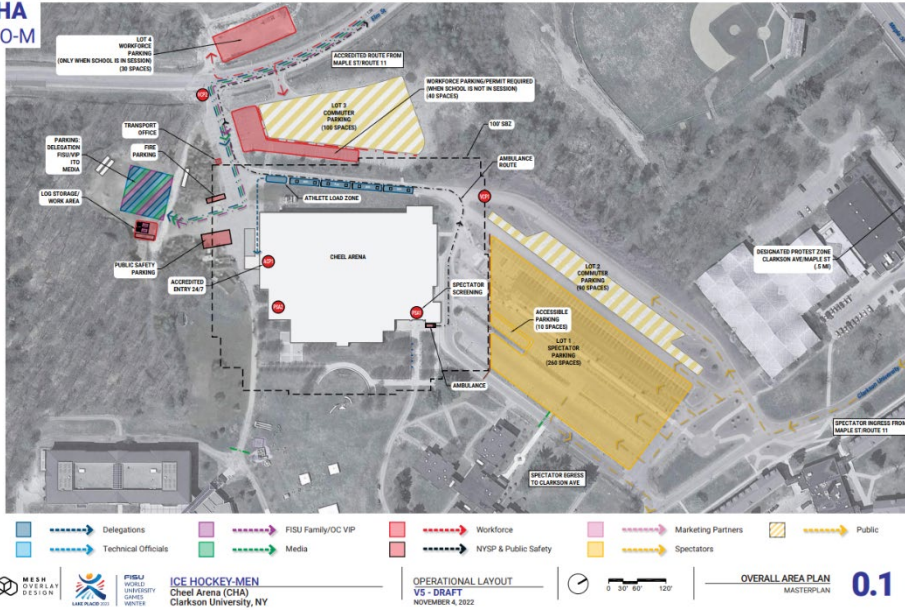

ROH
IHO-M

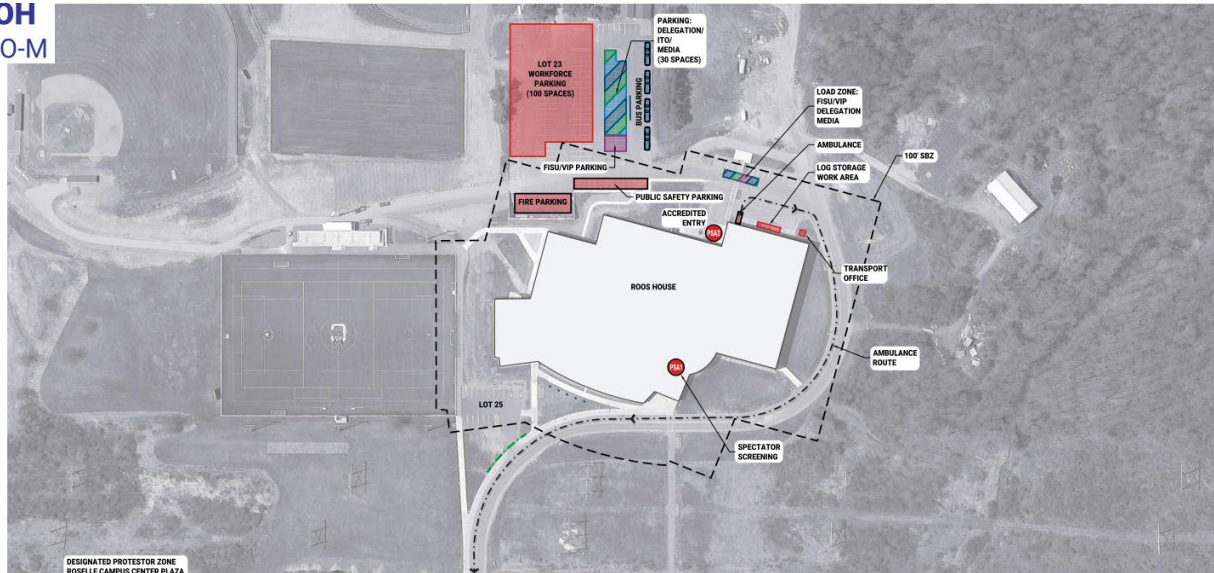

Women's

MAH
IHO-W

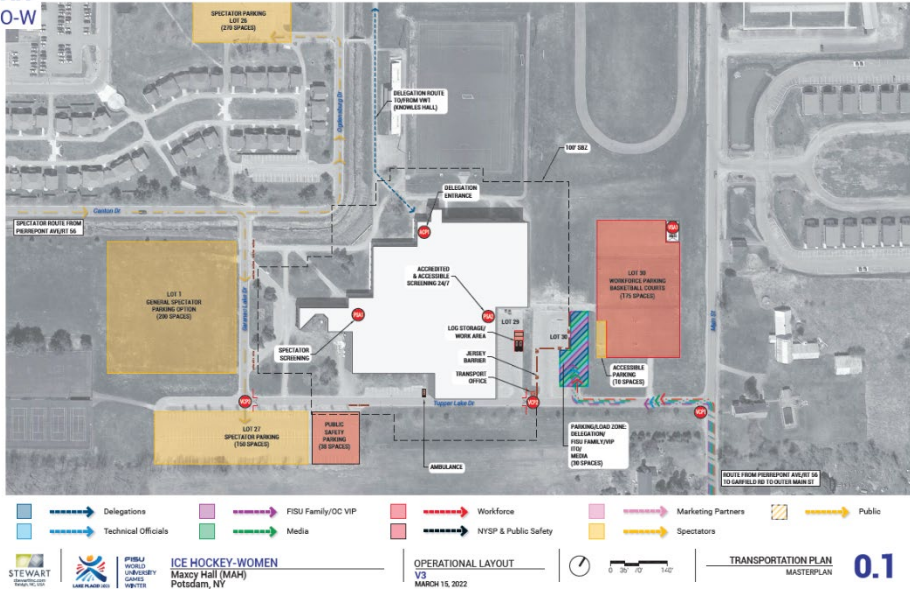



FISU
WORLD
UNIVERSITY
GAMES
WINTER

Thank You